

NRC Publications Archive Archives des publications du CNRC

Evaluation of thermal and moisture response of highly insulated wood-frame wall assemblies: Part I: experimental trials in the field exposure of walls test facility – phase 1 and phase 2

Lacasse, M. A.; Saber, Hamed H.; Maref, W.; Ganapathy, G.; Nicholls, M.

For the publisher's version, please access the DOI link below. / Pour consulter la version de l'éditeur, utilisez le lien DOI ci-dessous.

Publisher's version / Version de l'éditeur:

<https://doi.org/10.4224/23002862>

Client Report (National Research Council of Canada. Construction), 2016-01-08

NRC Publications Archive Record / Notice des Archives des publications du CNRC :

<https://nrc-publications.canada.ca/eng/view/object/?id=c20992ee-c99f-4f95-8094-58800da59849>

<https://publications-cnrc.canada.ca/fra/voir/objet/?id=c20992ee-c99f-4f95-8094-58800da59849>

Access and use of this website and the material on it are subject to the Terms and Conditions set forth at

<https://nrc-publications.canada.ca/eng/copyright>

READ THESE TERMS AND CONDITIONS CAREFULLY BEFORE USING THIS WEBSITE.

L'accès à ce site Web et l'utilisation de son contenu sont assujettis aux conditions présentées dans le site

<https://publications-cnrc.canada.ca/fra/droits>

LISEZ CES CONDITIONS ATTENTIVEMENT AVANT D'UTILISER CE SITE WEB.

Questions? Contact the NRC Publications Archive team at

PublicationsArchive-ArchivesPublications@nrc-cnrc.gc.ca. If you wish to email the authors directly, please see the first page of the publication for their contact information.

Vous avez des questions? Nous pouvons vous aider. Pour communiquer directement avec un auteur, consultez la première page de la revue dans laquelle son article a été publié afin de trouver ses coordonnées. Si vous n'arrivez pas à les repérer, communiquez avec nous à PublicationsArchive-ArchivesPublications@nrc-cnrc.gc.ca.

Evaluation of Thermal and Moisture Response of Highly Insulated Wood-Frame Wall Assemblies – Part I:

Experimental trials in the Field Exposure of Walls test Facility – Phase 1 and Phase 2

Report A1-000444.5

Lacasse, M. A., H. H. Saber, W. Maref, G. Ganapathy and M. Nicholls

8 January, 2016

Table of Contents

Table of Contents	iii
List of Figures.....	v
List of Tables	vii
Acknowledgements.....	ix
Executive Summary.....	xii
1. Introduction.....	1
1.1 Overview.....	1
1.2 Objectives	2
2.0 Research Approach	4
2.1 Scope of Testing	4
2.2 Description of Wall Specimens.....	4
Phase 1 Test specimens.....	4
Phase 2 Test specimens.....	7
Instrumentation	10
2.3 Test Protocol.....	12
2.4 Monitoring.....	14
3.0 Results	14
3.1 Response of Walls assemblies - Phase 1 (2013/14).....	14
3.2 Response of Walls assemblies - Phase 2 (2014/15).....	16
4.0 Summary of Response of Walls assemblies - Phases 1 and 2	20
5.0 References.....	21
Appendix 1 Test Specimen Fabrication and Installation details	23
Appendix 2 Test Specimen Sensor Installation Details.....	25
Phase 1 test specimens - Location of temperature thermocouples (TC)	25
Phase 1 test specimens - Location of relative humidity sensors (RH).....	27
Phase 1 test specimens - Location of Heat Flux (HF) transducers.....	28
Phase 2 test specimens - Location of pressure sensors (DP)	29
Phase 2 test specimens - Location of temperature thermocouples (TC)	30
Phase 2 test specimens - Location of Relative humidity sensors (RH)	31
Phase 2 test specimens - Location of moisture and liquid sensing tapes	32

W4 – Location of DETEC moisture sensing tapes in stud cavity	32
W5 – Location of DETEC moisture sensing tapes in stud cavity	32
W6 – Location of DETEC moisture sensing tapes in stud cavity	33
W4 – Location of DETEC moisture sensing tapes - presence of liquid in stud cavity.....	33
W5 – Location of DETEC moisture sensing tapes - presence of liquid in stud cavity.....	34
W6 – Location of DETEC moisture sensing tapes - presence of liquid in stud cavity.....	34
Appendix 3.....	36
Phase 1: Pressure variations over monitoring period	36
Phase 1: Temperature variations over monitoring period	37
Phase 1: W1 - Pressure, T and RH variations over period A	38
Phase 1: W2 - Pressure, T and RH variations over period A	39
Phase 1: W3 - Pressure, T and RH variations over period A	40
Phase 2: W4 - Variations in pressure, T & RH over time.....	41
Phase 2: W5 - Variations in pressure, T & RH over time.....	42
Phase 2: W6 - Variations in pressure, T & RH over time	43
Appendix 4 Mould Index and Hygrothermal Performance.....	45

List of Figures

Figure 1. NRC-Construction's Field Exposure of Walls (FEWF) test facility, located at the NRC Montreal Road campus in Ottawa.	3
Figure 2. Schematic of three 38 mm x 140 mm (2 x 6 in.) wood-frame wall (residential) test specimens installed side-by-side in FEWF.....	5
Figure 3. Wall 1 (W1: EPS) - Horizontal cross-section through EPS wall assembly showing locations of Heat Flux Transducers (HFT)	5
Figure 4. Wall 2 (W2: XPS) - Horizontal cross-section through XPS wall assembly showing locations of Heat Flux Transducers (HFT)	5
Figure 5. Wall 3 (W3: MF) - Horizontal cross-section through mineral fibre (MF) wall assembly showing locations of HFT	5
Figure 6. Installation of W1, W2, and W3 in FEWF showing exterior sheathing panel (OSB)	6
Figure 7. Installation of W1, W2, and W3 in FEWF showing sheathing membrane	6
Figure 8. Installation of W1, W2, & W3 in FEWF showing respective insulation panels including EPS (W1), XPS (W2) and MF (W3).....	6
Figure 9. Installation of W1, W2, & W3 in FEWF showing exterior cladding (vinyl siding).....	6
Figure 10. Schematic of three 38 x 140 mm (2 x 6 in.) wood-frame wall (residential) test specimens installed side-by-side in FEWF	8
Figure 11. Wall 4 (W4: XPS) - Horizontal cross-section through XPS wall showing locations of Heat Flux Transducers (HFT)	8
Figure 12. Wall 5 (W5: SPF) - Horizontal cross-section through SPF wall showing locations of Heat Flux Transducers (HFT)	8
Figure 13. Wall 6 (W6: CFI) - Horizontal cross-section through cellulose fibre (MF) wall showing locations of HFT ...	8
Figure 14. Wall 4 (XPS) – Interior wood frame prior to (i) & following installation GF batt insulation in stud cavities (ii), & placement of 51 mm of XPS insulation & PE vapour barrier (iii)	9
Figure 15. Wall 5 (SPF) - Interior wood frame prior to (i) & following installation SPF insulation in stud cavities (ii), & placement of 178 mm of GF insulation & PE vapour barrier (iii).....	9
Figure 16. Wall 6 (CFI) Interior wood frame prior to (i) & following installation of cellulose fibre insulation in stud cavities (ii), & PE.....	9
Figure 17. Interior of FEWF showing W4 (XPS), W5 (SPF), and W6 (CFI) prior to (i) & following (ii) installation of interior drywall.....	9
Figure 18 – Deficiencies in wall test specimens showing location & size of deficiency in W4 (XPS)	13
Figure 19 – Response of respective wall assemblies (Temperature [T]; RH at interior OSB surface and dew point T) over monitoring period (2013/14); (i) W1 (EPS); (ii) W2 (XPS); (iii) W3 (Mineral fibre)	15
Figure 20 – Response of test wall W4 (XPS) to local weather of Ottawa (ON), Canada – having a nominal R-value of R33;.....	18
Figure 21 – Response of test wall W5 (SPF) to local weather load of Ottawa (ON), Canada – having a nominal R-value of R42;.....	18
Figure 22 – Response of test wall W6 (CFI) to local weather of Ottawa (ON), Canada – having a nominal R-value of R40;.....	18
Figure 23 – W4 : Response of moisture detection strip to the presence of moisture in the wall.....	19
Figure 24– W5: Response of moisture detection strip to the presence of moisture in the wall.....	19
Figure 25– W6: Response of moisture detection strip to the presence of moisture in the wall.....	19
Figure 26– summary of Response of Walls assemblies - Phases 1 and 2	21

List of Tables

Table 1. List of sensors used to determine hygrothermal response of test specimens to changing local exterior and interior conditions	10
Table 2 – Selected array of sensors deployed within wall assembly of test specimen W1	11
Table 3. Phase 1 (2013/14) - Test protocol over monitoring period	12
Table 4. Phase 2 (2014/15) - Test protocol over monitoring period	13
Table 5 – Air leakage (ξ) characterization of test specimens	13
Table 6. Description of Mould Index (M) levels [6, 7, 8]	45
Table 7. Mould growth sensitivity classes and some corresponding materials [8]	45
Table 8. Mould growth sensitivity classes for materials of wall assemblies listed in Table 3	45

Acknowledgements

The authors wish to thank Canada Mortgage and Housing Corporation (CMHC) and Natural Resources Canada (NRCan) for contributing funding for this project. The authors wish to thank the Project Advisory Committee that included: Constance Thivierge (formerly with FP Innovations), Doug Tarry (Doug Tarry Homes), Rick Gratton (CHBA), Christopher McLellan (CHBA), Chris Mattock (Habitat Design and Consulting), Salvatore Ciarlo (Owens Corning Canada) and Robert Jonkman (Canadian Wood Council). Also, the authors wish to thank NRC-Construction for providing the funding to enable researchers to build, operate and maintain a state-of-the-art Field Exposure of Walls Facility (FEWF) that was used in this project.

Executive Summary*

Over the years, the energy efficiency of the North American housing stock has significantly improved mainly due to higher insulation levels, more efficient windows and, more importantly, adoption of various energy efficiency measures by building codes. The increased insulation levels of building envelopes for homes leads to a multitude of opportunities as well as challenges. A major opportunity is to reduce heat losses and thereby significantly reducing the space heating loads. However, there are many challenges that necessitate changes in the current construction process, durability of products, and more importantly, the effect of higher insulation levels on the overall moisture performance and expected long-term performance of the building envelope. A major barrier to the uptake of highly insulated homes is the lack of proven evidence of reliable thermal and moisture performance of these homes as might be achieved in various climates of Canada.

The National Research Council of Canada (NRC) has undertaken field monitoring and computer modelling to investigate the risk of condensation in wall assemblies having different combinations of increased thermal resistance (R-value) of cavity insulation and of selected exterior insulation products. A set of three wall assemblies with different types of exterior insulation systems were chosen for the field study for the first year and in the second year, a subsequent set of three walls. The initial set of three wall assemblies range from total insulation value of RSI-4.96 to RSI 6.38 (R-28 to R-36). Full scale testing included year-round performance monitoring. These wall specimens were installed in a side-by-side test bay and were subjected to local climate conditions of Ottawa, Canada; on the interior of the specimens conditions were nominally maintained at 20°C and 50% RH. This report provides results of field trials of the six wall assemblies in terms of their hygrothermal performance and risk for condensation over a two year period of operation.

* This report may not be reproduced in whole or in part without the written consent of both the client and the National Research Council of Canada

Evaluation of Thermal and Moisture Response of Highly Insulated Wood-Frame Wall Assemblies — Part I:

Experimental trials in the Field Exposure of Walls test Facility — Phase 1 and Phase 2

M. A. Lacasse, H. H. Saber, W. Maref, G. Ganapathy and M. Nicholls

1. Introduction

1.1 Overview

The Canadian market for new residential home construction and existing retrofits was about 79 million m², which represents an investment of about CDN \$9.7 billion in 2012 [1].

Conservatively assuming a 25% market share by 2025, highly-insulated (enhanced) envelopes could save 11.6 PJ of energy and 1.2 Mt of Green House Gas per year [2]. This represents a significant economic opportunity for the housing industry within Canada and fore value-added exports such as manufactured panelized wall systems. This project is needed to provide the scientific data and analysis necessary to characterize the thermal and moisture performance of advanced residential wall systems. Such information is needed to inform any considerations for further energy efficiency improvements to building codes and voluntary residential energy efficiency program requirements. Evidence is needed to guide the development of highly energy efficient, cost-effective, durable and buildable solutions that are well-integrated with Canadian housing system practices.

Given the heightened interest of homebuilders to provide homes that met or exceeded Energy Star requirements, and their voiced concerns regarding “super-insulated” homes, the intent of this work was to demonstrate compliance of a set of highly-insulated wall assemblies as compared to a code compliant reference wall in respect to their anticipated thermal and hygrothermal performance when subjected to Canadian climate extremes. On the basis of providing useful information to building practitioners, the National Research Council Canada (NRC) undertook field monitoring and numerical modelling to investigate the risk of condensation in wall assemblies having different combinations of increased thermal resistance (R-value) of insulation for selected insulation products.

To achieve higher wall insulation levels in wood-frame wall assemblies, it has been commonplace to apply rigid, or semi-rigid, board insulation over the inside or outside of the framing. Alternatively, double wall or deep wall construction assemblies can be used to attain the desired level of insulation. However, concerns had been expressed in the building community regarding the use of progressively higher levels of insulation in wall assemblies as a means of attaining greater energy savings. It was felt that the use of higher insulation levels would increase the risk of incurring moisture problems given the perceived effect that highly insulated walls have on the wetting and drying characteristics of walls.

To help address the development of such unintended consequences, a collaborative research project, with government and industry participation, was initiated to explore, develop, test and document the energy performance and moisture response of highly insulated residential wall systems. The information derived from the project will be used to guide the development of durable new wood frame wall assemblies.

1.2 Objectives

The intent of the project was to develop information on the moisture and thermal performance of progressively higher insulated wood-frame wall assemblies. The information is to be used to: (1) Support the evaluation of future code proposals regarding energy efficiency improvements to building envelope systems; (2) Support the development of knowledge, details and practices for advanced wall systems for voluntary residential energy efficiency programs; (3) Help the housing industry meet near- and net-zero energy targets, and; (4) Promote the deployment of highly energy efficient wall details for new and retrofitted existing wood-frame construction. In essence, the primary outcome from this project is to facilitate the widespread adoption of high performance residential wood-frame wall systems (EGH-83 and 86) that are practical, buildable, durable, energy efficient and affordable.

To achieve these objectives, the project focused on investigating the moisture and energy performance of thermally enhanced wood-frame walls with progressively higher levels of insulation from a base line (2010 National Building Code minimum (RSI 3.27 – 4.13) to new R-2000 performance levels (RSI 7.04 – 7.92). It permitted comparing the heat, air and moisture response of the advanced wall systems to the base line code compliant wall and thereafter complete the necessary analysis to develop meaningful information outputs that could be used to address and thereby alleviate industry concerns regarding the unintended consequences of enhanced wall insulation systems on the moisture performance of the wall assemblies over time.

The National Research Council of Canada (NRC-Construction) in collaboration with the Canada Mortgage and Housing Corporation (CMHC) and Natural Resources Canada, industry partners that included the: Canadian Wood Council (CWC), Homeowners Protection Office of British Columbia (HPO), and the Cellulose Insulation Manufacturers Association of Canada (CIMAC), developed proposals for 6 wall assemblies that could be used in progressively higher

performing houses between baseline code to R-2000 levels. The wall assemblies were tested 3 at a time in NRC-Construction's Field Exposure of Walls (FEWF) test facility, shown in FIGURE 1, over a period of 9-months in a yearly cycle where the walls were exposed to outdoor conditions.

As it was of importance to ensure that the results of the research were meaningful in all regions of Canada, the analysis was extended through the use of simulation tools to representative cities in the Atlantic and Prairie regions of Canada, the lower coastal mainland of BC and in the North. Given that conducting experimental tests to determine the hygrothermal performance of different wall systems in different Canadian locations is time consuming and expensive, an advanced hygrothermal modeling tool was used in this project. The modeling tool (hygIRC-C) was benchmarked against experimental data obtained from Phase 1 and Phase 2 of the project [3]. Once the benchmarking of the modeling tool was completed, it was then used to investigate the effect of different outdoor and indoor conditions, as may be found in the different regions of Canada, on the moisture and thermal performance of the wall assemblies.

In this report, results are provided of the monitoring of the hygrothermal response of a set of six highly insulated wall assemblies to local climate conditions of Ottawa and when subjected to forced exfiltration conditions.



Figure 1. NRC-Construction's Field Exposure of Walls (FEWF) test facility, located at the NRC Montreal Road campus in Ottawa.

2.0 Research Approach

2.1 Scope of Testing

The field monitoring of the six (6) different wall assemblies was undertaken in two separate Phases over a two year period in the NRC's Field Exposure of Walls Facility (FEWF), located at the NRC campus in Ottawa. Three (3) wall assemblies were tested in the initial year of Phase 1 of the project and another three (3) wall assemblies were tested in Phase 2 of the second project year. The research approach was similar to that used in previous projects where there was interest in knowing the hygrothermal response of wall assemblies subjected to local climate conditions as described by Armstrong et al. [9], Maref et al. [10, 11] and Saber et al. [12, 12].

Field monitoring of the test specimens was conducted, for Phase 1 from June 2013 to October 2014 and for Phase 2 from January 2015 to September 2015; this allowed a 9-month period over which test specimens were subjected to a broad range of weather conditions for each set of experiments

2.2 Description of Wall Specimens

Phase 1 Test specimens

The three wall test specimens of Phase 1 (1219 mm x 1829 mm / 4 ft. x 6-ft.) consisted of 38 mm x 140 mm (2 x 6-in.) wood-frame walls installed side-by-side in the FEWF (Figure 2). The different material layers and the dimensions of the wall specimens are given in Figure 3 to Figure 5. The backup wall for all three design strategies consisted of interior drywall ((12.7 mm / 0.5 in) thick), polyethylene air and vapour barrier (6 mil thick), 38 mm x 140 mm (2 x 6-in.) wood-frame wall with friction-fit glass fibre batt insulation of R-24, and oriented strand board (OSB) (11 mm / 7/16 in. thick). The test specimens were constructed by adding different types of exterior insulation products of different thicknesses to the backup wall. The first wall (Wall 1; Figure 3) was constructed by adding an expanded polystyrene (EPS) layer of 25 mm (1 in) thick onto the OSB sheathing, yielding a nominal R27. The second wall (Wall 2; Figure 4) was constructed with a 51 mm (2 in) thick extruded polystyrene (XPS) panel and nominally provided R35. The final wall (Wall 3; Figure 5) was constructed with 76 mm (3 in) thick mineral fibre insulation, thereby providing an R35.

The sequence of installation of the primary wall components forming the exterior portion of the respective test specimens of Phase 1, and outboard of the 38 mm x 140 mm (2 x 6 in.) wood framing, is illustrated in Figure 6 to Figure 9. In Figure 6 is shown a state of fabrication where the exterior sheathing panel (OSB) has been installed for the different test specimens (W, W2, and W3); thereafter, as evident in Figure 7, the sheathing membrane overlaid the OSB panel. Following this sequence, and as is given in Figure 8, each of the different insulation products (25 mm EPS, 51 mm XPS, 76 mm MF) was installed atop the protective membrane. This was followed by the installation of wood furring strips to which was affixed the exterior cladding; this final installation sequence is provided in Figure 9, and in which is shown the vinyl siding.

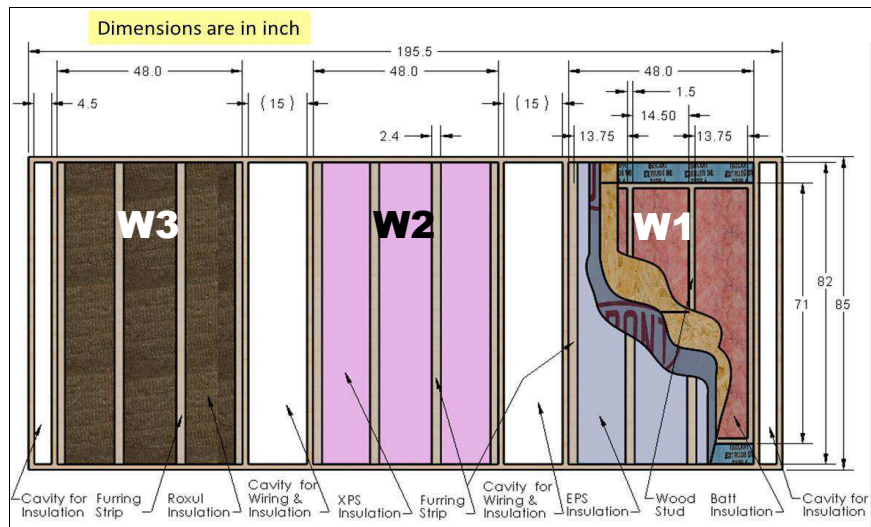

Figure 2. Schematic of three 38 mm x 140 mm (2 x 6 in.) wood-frame wall (residential) test specimens installed side-by-side in FEWF



- Vinyl siding
- 1.5-in. x 7/16" thick vertical furring strips
- 25 mm (1-in.) EPS rigid foam insulation (exterior insulation)
- Sheathing membrane
- 11 mm OSB wood-sheathing
- 2x6-in. nominal stud cavity with R24 glass fiber insulation batts
- 6 mil poly air/vapour barrier
- ½ in. painted drywall



Figure 3. Wall 1 (W1: EPS) - Horizontal cross-section through EPS wall assembly showing locations of Heat Flux Transducers (HFT)



- Vinyl siding
- 1.5 in wide x 7/16" thick vertical furring strips
- 51 mm (2 in.) XPS rigid foam insulation (exterior insulation)
- Sheathing membrane
- 11 mm OSB wood-sheathing
- 2x6-in. nominal stud cavity with R24 glass fiber insulation batts
- 6 mil poly air/vapour barrier
- ½ inch painted drywall

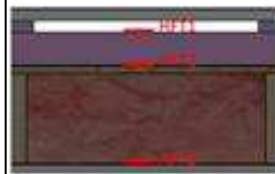

Figure 4. Wall 2 (W2: XPS) - Horizontal cross-section through XPS



- Vinyl siding
- 1.5-in. x 7/16" thick vertical furring strips
- 76 mm (3-in.) semi-rigid mineral fibre insulation (exterior insulation)
- Sheathing membrane
- 11 mm OSB wood-sheathing
- 2x6-in. nominal stud cavity with R24 glass fiber insulation batts
- 6 mil poly air/vapour barrier
- ½ in. painted drywall



Figure 5. Wall 3 (W3: MF) - Horizontal cross-section through

wall assembly showing locations of Heat Flux Transducers (HFT)



Figure 6. Installation of W1, W2, and W3 in FEWF showing exterior sheathing panel (OSB)

mineral fibre (MF) wall assembly showing locations of HFT



Figure 7. Installation of W1, W2, and W3 in FEWF showing sheathing membrane



Figure 8. Installation of W1, W2, & W3 in FEWF showing respective insulation panels including EPS (W1), XPS (W2) and MF (W3)



Figure 9. Installation of W1, W2, & W3 in FEWF showing exterior cladding (vinyl siding)

Phase 2 Test specimens

The three wall test specimens of Phase 2 (1219 mm x 1829 mm / 4 ft. x 6-ft.) are shown in Figure 10 to Figure 13 and were, as before, installed side-by-side in the FEWF (Figure 10). The common elements of all three test specimens were, towards the exterior of the assemblies, the vinyl siding, polymer-based sheathing membrane, and 11 mm OSB wood-sheathing panel, and for the interior finish, a 6 mil polyethylene air and vapor barrier and a 12.5 mm drywall panel. All walls were of wood frame construction, the difference being that the W4 frame nominally consisted of 38 mm x 140 mm (2 x 6-in.) framing, that for W5, 38 mm x 255 mm (2x10-in.) framing and for W6, 38 mm x 305 mm (2 x 12-in.) framing.

The primary insulation materials for W4 (XPS; Figure 11) were: R24 glass fiber batt insulation over which and towards the interior was installed 51 mm (2 in.) of XPS rigid foam insulation; the overall nominal thermal resistance for W4 (XPS) was R34. For W5 (SPF; Figure 12), the primary insulation materials were: ca. 2.4 in. of Spray Polyurethane Foam (SPF) applied on the interior surface of the OSB sheathing panel and 6.6-in. of glass fiber batt insulation; the overall nominal thermal resistance for W5 (SPF) was R45. For W6 (CFI; Figure 13), the insulation products consisted of cellulose fiber insulation providing a nominal R-value of R40.

Whereas for W4 (XPS) and W5 (SPF) the full depth of the vertical studs was used across the wall assembly, for W6 (CFI), 2 x 4-in. framing was used in the central stud cavity on the exterior and interior of the wall; this arrangement is more clearly evident from the horizontal sectional view provided in Figure 13.

The sequence of installation of the primary wall components forming the interior portion of the respective test specimens of Phase 2 (i.e. W4, W5, and W6) is illustrated in Figure 14 to Figure 17. In Figure 14 is shown the interior 38 mm x 140 mm (2 x 6-in.) wood frame of test specimen W4 prior to (Figure 14 (i)) and following the installation (Figure 14 (ii)), of Glass Fibre (GF) batt insulation in the stud cavities. The placement of 51 mm of XPS insulation and the polyethylene (PE) vapour barrier is shown in Figure 14 (iii).

In Figure 23, test specimen W5 (SPF) is shown, and in which is seen the interior 38 mm x 255 mm (2x10-in.) wood frame prior to installation of spray polyurethane foam (SPF) insulation (Figure 23 (i)) and in Figure 23 (ii), following the of installation of SPF in the stud cavities. Placement of the PE vapour barrier to W5 is shown in Figure 23 (iii).

The sequence of fabrication towards the interior of test specimen W6 (CFI) is shown in Figure 24; the 38 mm x 305 mm (2 x 12-in.) double stud wood frame is shown prior to installation of the cellulose fibre insulation (CFI) in the stud cavities and following the installation of the CFI and PE vapour barrier, in Figure 24 (ii).

In interior of all three test specimens is shown in Figure 25, prior to (Figure 25 (i)) and following the installation of the interior drywall (Figure 25 (ii)).

Additional installation details for test specimens of Phase 2 can be found in Appendix 1 Test Specimen Fabrication and Installation details)

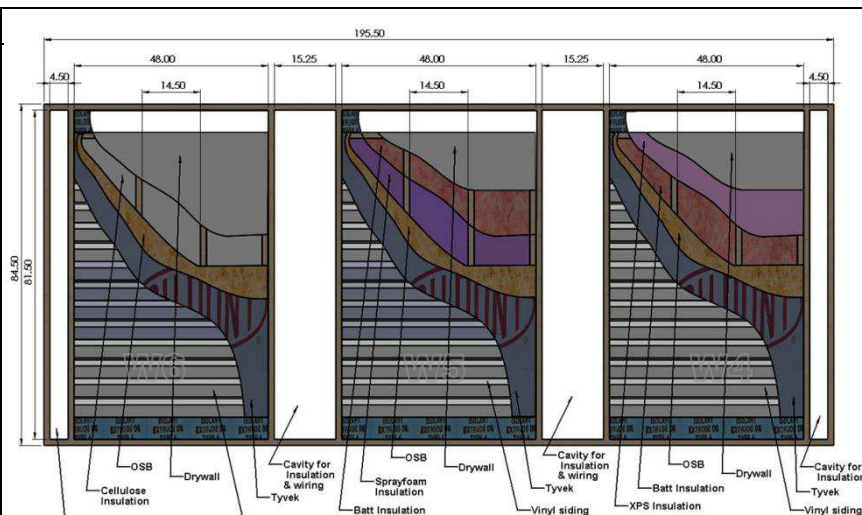

Figure 10. Schematic of three 38 x 140 mm (2 x 6 in.) wood-frame wall (residential) test specimens installed side-by-side in FEWF



- Vinyl siding
- Sheathing membrane
- 11 mm OSB wood-sheathing
- 2x6-in. nominal stud cavity with R24 glass fiber batt insulation
- 51 mm (2 in.) XPS rigid foam insulation
- 6 mil poly air/vapour barrier
- ½ in. painted drywall

Total R-30:

R-10 XPS (2-in.)

Figure 11. Wall 4 (W4: XPS) - Horizontal cross-section through XPS wall showing locations of Heat Flux Transducers (HFT)

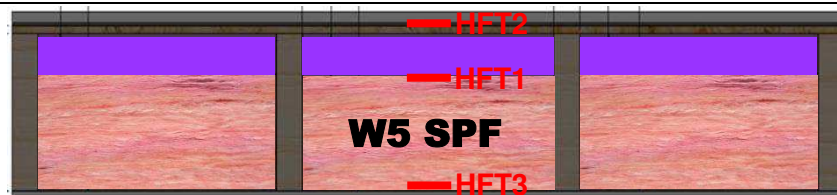

- Vinyl siding
- Sheathing membrane
- 11 mm OSB wood-sheathing
- 2x10-in. nominal stud cavity
- In Stud cavity
 - ~ 2-in. Spray polyurethane foam insulation
 - ~ 7-in. R24 glass fiber batt insulation
- 6 mil poly air/vapour barrier
- 12.5 mm (½-in.) painted drywall (gypsum board)

Total R-45:

R-16.2 SPF (2.38" thick)

R-28.8 GF (6.62" thick)

Figure 12. Wall 5 (W5: SPF) - Horizontal cross-section through SPF wall showing locations of Heat Flux Transducers (HFT)

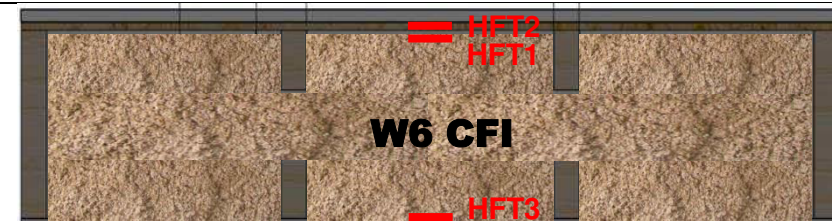

- Vinyl siding
- Sheathing membrane
- 11 mm OSB wood-sheathing
- 2x12-in. nominal stud cavity with R3.5/in. X 11-in. =
- R39 cellulose fiber insulation
- 6 mil poly air/vapour barrier
- ½ in. painted drywall

Total R-40:

R-39.5 Cellulose (11"thick)

Figure 13. Wall 6 (W6: CFI) - Horizontal cross-section through cellulose fibre (MF) wall showing locations of HFT



Figure 14. Wall 4 (XPS) – Interior wood frame prior to (i) & following installation GF batt insulation in stud cavities (ii), & placement of 51 mm of XPS insulation & PE vapour barrier (iii)



Figure 15. Wall 5 (SPF) - Interior wood frame prior to (i) & following installation SPF insulation in stud cavities (ii), & placement of 178 mm of GF insulation & PE vapour barrier (iii)



Figure 16. Wall 6 (CFI) Interior wood frame prior to (i) & following installation of cellulose fibre insulation in stud cavities (ii), & PE



Figure 17. Interior of FEWF showing W4 (XPS), W5 (SPF), and W6 (CFI) prior to (i) & following (ii) installation of interior drywall

Instrumentation

For the characterization of the hygrothermal response of the walls, the test specimens were instrumented with different sensors to characterize heat transfer across the specimens, to establish values for surface temperature and local relative humidity as well as the presence of moisture accumulation and pressure differences across the different layers; the different sensors used in this study are listed in Table 1.

For each test specimen, an array of sensors was deployed in a grid at each layer of the assembly; an example of the array of sensors deployed within wall assembly of test specimen W1 is shown in Table 2, the broader set of sensors for all test specimens of Phase 1 and Phase 2 are provided in Appendix 2 (Test Specimen Sensor Installation Details).

A local weather monitoring device (Vaisala Model WXT 510), that included a rain gauge, sensors for air temperature, relative humidity, air pressure, wind speed and wind direction, was installed in close proximity to the wall specimens and provided information on hourly ambient exterior conditions. The combined package permitted determining the response of the respective wall assemblies to changing weather conditions over hourly, daily and seasonal periods.



Vaisala Model WXT

For each project Phase, each of the three test specimens was isolated from each other by a vertical chase that provided effective control of heat, air and moisture flow and as well provided room for running wires for instrumentation (Figure 2 and Figure 10). The test specimens were also isolated from the surrounding building envelope of the test house with effective heat, air and moisture control materials (e.g. thermal insulation and self-adhered airtight membranes were used), as well as flashings where warranted.

As a part of the test protocol all HFTs used in the test specimens were calibrated according to ASTM C-1130 “Standard Practice for Calibrating Thin Heat Flux Transducers” [4]. The uncertainty of the heat flux measurements was $\pm 5\%$. The locations of the HFTs in the respective test specimens are shown in Figure 2 to Figure 4.

Table 1. List of sensors used to determine hygrothermal response of test specimens to changing local exterior and interior conditions

Sensors	Manufacturer / Supplier	Model	Range	Accuracy
Thermocouple	Omega	TT-T-24-SLE	-100°C to +200°C	0.5°C or 0.4% FS
RH&T	Vaisala	HMP-60	RH: 0 to 100%; Temp.: - 40°C to +60°C	RH : $\pm 5\%$ Temp.: $\pm 0.6^\circ\text{C}$
Pressure	Setra	C264	$\pm 0.25''\text{WC}$ & $\pm 2.5''\text{WC}$	$\pm 1\%$ FS
Heat flux sensors	Hukseflux	PU11T & PU32T	-20°C to + 60°C	$\pm 5\%$ at 20°C
Moisture tapes	Detec & SMT	N/A	Up to 40% moisture content	

Table 2 – Selected array of sensors deployed within wall assembly of test specimen W1

W1 – Location of thermocouple (T)		Designation		
Exterior temperature	B1_TC_01		+	
Exterior temperature	B1_TC_02		+	
Behind cladding at top	B1_TC_03		+	
Behind cladding at bottom	B1_TC_04		+	
T at EPS-OSB interface at top	B1_TC_09		+	
T at EPS-OSB interface at bottom	B1_TC_10		+	
OSB interior surface T at top	B1_TC_11		+	
Interior T	B1_TC_17		+	
Dew point Interior T	B1_TC_18		+	
W1 – Location of RH sensors		Designation		
Exterior RH	B1_RHT_01		x	
Behind cladding at top	B1_RHT_02		x	
Behind cladding at bottom	B1_RHT_03		x	
EPS-OSB interface at top	B1_RHT_04		x	
EPS-OSB interface at bottom	B1_RHT_05		x	
OSB interior surface RH at top	B1_RHT_06		x	
Interior surface RH	B1_RHT_08		x	
W1 – Location of HF transducers		Designation		
Exterior surface of EPS	B1_HFT_01		•	
Exterior surface of OSB panel	B1_HFT_02		•	
Exterior facing surface of drywall	B1_HFT_03		•	
W1 – Location of thermocouple (T)		Designation		
Middle stud cavity at top	B1_TC_12		+	
Mid-height stud cavity – right cavity	B1_TC_13		+	
Middle stud cavity at bottom	B1_TC_14		+	
Mid-height stud cavity – left cavity	B1_TC_15		+	

2.3 Test Protocol

The test protocol was conceived to ensure that the wall assemblies were monitored to assess their vapour diffusion characteristics over a 9 month period, the initial period (A) covering the coldest period of the year.

The test protocol consisted of exposing the wall specimens to:

- Exterior weather conditions prevalent at the FEWF test site;
- A set of indoor controlled temperature and humidity conditions.

Indoor controlled conditions were based on that provided in ASHRAE standards [5] as these relate to indoor winter and summer conditions (20°C; 35% RH). To attain these conditions, an indoor climatic chamber was installed and sealed against the perimeter of the test opening, thereby allowing control of indoor conditions to which test specimens were subjected.

Test Periods — The monitoring program was set-up in four (4) periods (A, B, C and D) as provided in Table 3 for Phase 1, and in Table 4 for Phase 2. The length of periods varied, but in essence the initial period, Period A, was intended as a period over which the fluctuations of heat flow, temperature, relative humidity and pressure differences within the assembly were monitored to gain an appreciation of the response of the wall to local weather conditions and when the interior conditions were nominally maintained at 21°C and 35% RH. Period B was meant to subject specimens to conditions where warm moist air (21°C; 50% RH) exfiltrated through intended deficiencies in the test specimens; exfiltration was induced by applying a 10 Pa pressure across the test specimens from the interior enclosure. In this instance, there was interest in bringing about condensation on cold surfaces within the wall. The subsequent period, period C, provided a short period over which the deficiencies remained in the assembly but no exfiltration pressure was applied to the enclosure and interior RH conditions were not controlled to a set RH level as they were for periods A and B. As such, the wall might recover from moisture deposition within the wall and in essence, “dry out”. In this way, the propensity for the wall to dry out following occurrences of moisture deposition within the wall provided a means to assess the robustness of the moisture management ability of the wall assembly. The final period (Period D), was again intended as a period over which to gain an understanding of the response of the wall to increasingly cooler periods following the summer months; the deficiencies were not present in this instance and neither was the RH in the interior enclosure maintained to a set level.

Table 3. Phase 1 (2013/14) - Test protocol over monitoring period

Period	Interior conditions				Exterior conditions	
	Temperature (°C)	RH (%)	Pressure (Pa)	Deficiency (3mm slit)	Deficiency (3mm slit)	Temperature / RH
A (175 days)	21	35	0	Closed	Open	Ambient local
B (20 days)	21	50	10	Open	Open	Ambient local
C (40 days)	21	Variable / natural	0	Open	Open	Ambient local
D (100 days)	21	Variable / natural	0	Closed	Open	Ambient local

Table 4. Phase 2 (2014/15) - Test protocol over monitoring period

Period	Interior conditions				Exterior conditions	
	Temperature (°C)	RH (%)	Pressure (Pa)	Deficiency (3mm slit)	Deficiency (3mm slit)	Temperature / RH
A (40 days)	21	35	0	Closed	Open	Ambient local
B (9 days)	21	Variable / natural	Variable	Open	Open	Ambient local
C (47 days)	21	Variable / natural	0	Open	Open	Ambient local
D (167 days)	21	Variable / natural	0	Closed	Open	Ambient local

Deficiencies in the wall assembly — Each test specimen included a deficiency through which air from the interior was meant to exfiltrate through the test specimens. The size and location of the respective deficiencies are shown in Figure 18. Pressure differences across the assemblies, occurring either naturally or through forced air flow to the interior enclosure, induced the flow of air through the deficiencies as suggested in the schematic on the right of the photos in Figure 18. The location of the deficiencies at the interior of the test specimens and at the exterior sheathing panel, in principal, permitted a path for air to flow. The air leakage rate at several different enclosure pressures for each of these deficiencies was determined the results of which are given in Table 5. These are given as the leakage rate (L/min.) as a function of pressure difference (Pa) in the exfiltration mode. The coefficients for the best fit equation are given for each test wall as is the degree of fit (R^2). Of importance are the values of air leakage at the exfiltration mode when the deficiencies were present in the walls (Period B-“Deficiency state”).

**Figure 18 – Deficiencies in wall test specimens showing location & size of deficiency in W4 (XPS)****Table 5 – Air leakage (ξ) characterization of test specimens**

Phase	Wall	$\xi \text{ (L/min)} = a \Delta P^b$	
		a	b
Phase 1	W1	73.5	0.320
	W2	75.9	0.316
	W3	53.4	0.300
Phase 2	W4	0.685	0.989
	W5	0.654	0.766
	W6	0.593	0.953

* ΔP in Pa

2.4 Monitoring

Data was gathered continuously over a 9-month period and data analysis consisted of reviewing relevant sensors within the assembly and determining whether there was risk to the formation of condensation within the respective assemblies over the evaluation period.

On the basis of results obtained from monitoring the response of the respective wall assemblies to local climate conditions, the numerical hygrothermal model hygIRC-C was benchmarked against selected experimental data. Thereafter, the model was used to conduct a parametric analysis to investigate the risk of condensation and mould growth in the respective wall assemblies subjected to different climatic conditions for a select set of locations in Canada. A description of the hygIRC-C numerical hygrothermal simulation model and record of benchmarking exercises are available in [3].

3.0 Results

Results are provided for Phase 1 and thereafter for Phase 2 of the project. In each of these sections, the hygrothermal response of wall test specimens to local climate conditions is described and those instances when moisture from condensation within the wall assembly was observed are discussed. The information acquired from the monitoring program for Phase 1 and Phase 2 is quite considerable and additional details of this can be found in Appendix 3.

3.1 Response of Walls assemblies - Phase 1 (2013/14)

The hygrothermal response of those test specimens evaluated in Phase 1 over the monitoring period of ca. 11 months is shown in Figure 19 for the respective test specimens: (i) W1-EPS; (ii) W2-XPS, and; (iii) W3-MF. The location of the temperature and relative humidity sensors for which values are provided in the figure are shown in the diagram adjacent to the plots. In the plot of Figure 19 the values recorded for the interior surface temperature and relative humidity of the OSB sheathing panel at mid-height of the wall are shown over the 4 periods of the test protocol (i.e. A, B, C, and D). The daily fluctuations in temperature of both the interior surface of the OSB and well as the interior dew point temperature are superimposed on the seasonal variations; the OSB interior surface gradually rise from below zero °C to upwards of 25°C with maximum values attaining > 30°C in Period C (May -July) and the beginning of period D (July-August). The relative humidity at the interior surface of the OSB panel varies over the monitoring period between ca. 55% and 35%, the lowest values being recorded during period B of the monitoring program.

Period B of the monitoring program was intended to bring about occurrences of condensation within the wall assembly. As noted in Figure 19, this was the “deficiency state” when warm moist air from the interior was to exfiltrate to the exterior of the test specimens under forced flow conditions. Period B was completed over a three week period at the beginning of May (2 May to 22 May 2014). This being the case, and given that the surface temperature of the interior of the OSB sheathing panel had already attained a minimum temperature of ca. 7°C, it was unlikely that any surface condensation would occur given as well that this surface temperature was well

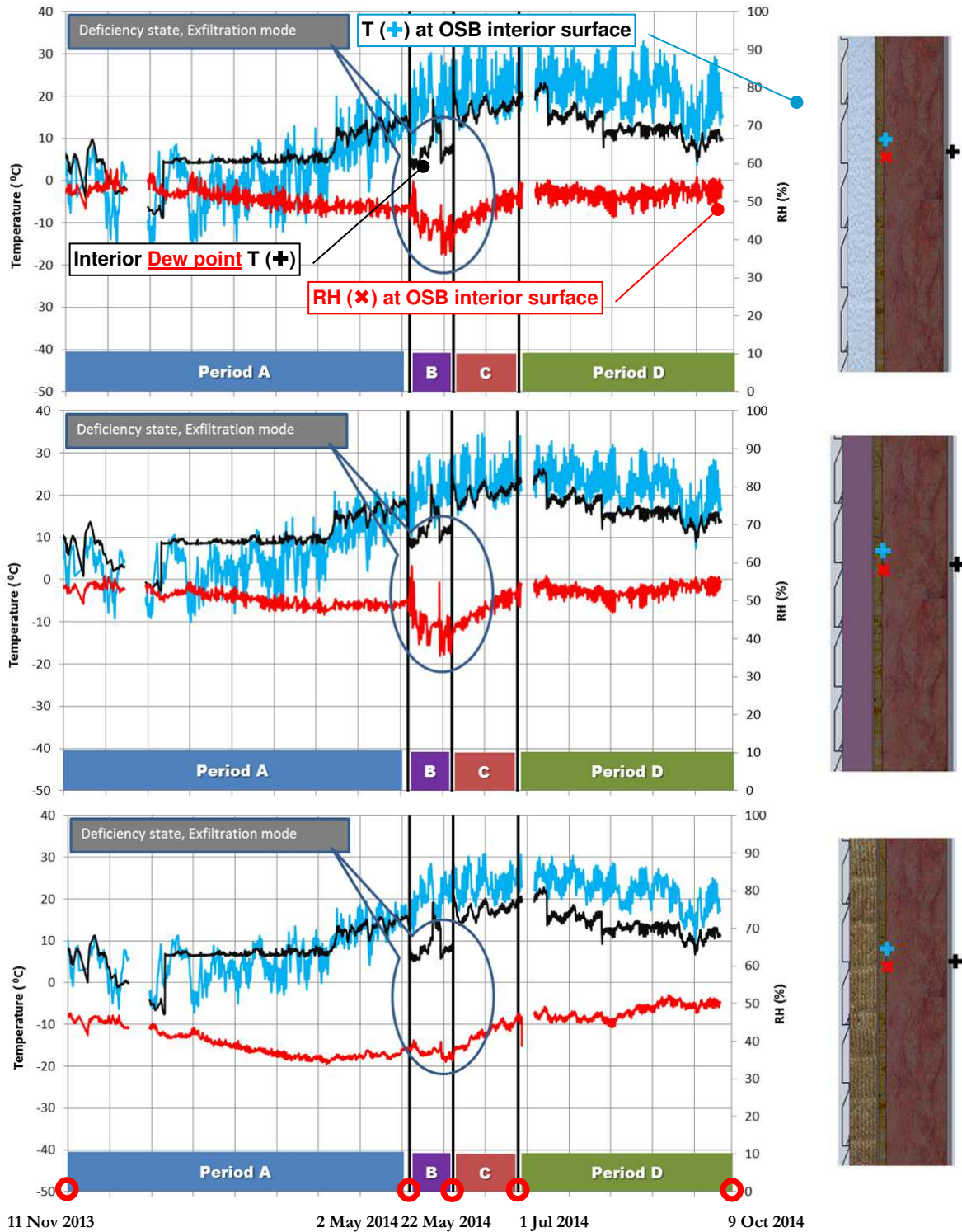

Figure 19 – Response of respective wall assemblies (Temperature [T]; RH at interior OSB surface and dew point T) over monitoring period (2013/14); (i) W1 (EPS); (ii) W2 (XPS); (iii) W3 (Mineral fibre)

above the interior dew point temperature. Consequently, no condensation was induced in this period for any of the walls tested. Then again, neither was any condensation evident for any of the walls over all other periods monitored in Phase 1; this was also visually verified when the walls were taken down following the end of Phase 1.

3.2 Response of Walls assemblies - Phase 2 (2014/15)

The hygrothermal response of the test walls of Phase 2 (W4, W5, W6) are each dealt with in turn.

Response of W4 (XPS) — The response of W4 is provided in plots of relative humidity and temperature (RH & T) as a function of the monitoring period in days as provided in Figure 20. The different periods (A to D, inclusive) are highlighted at the base of the figure. The uppermost plot represents the RH (blue color) and T (red color) on the surface of the interior side of the OSB at approximately mid-height of the wall and in proximity to the 3 mm slit through which air could exfiltrate the wall. For the middle plot, the values for temperature given at the bottom of the wall were found to be much lower than that for the top of the wall (by perhaps 20°C), and given in the uppermost plot; the lower temperatures in the bottom plot were considered inaccurate and consequently, in the middle plot it was deemed appropriate to use the values for temperature obtained from the top of the wall as given in the uppermost plot. The middle plot thus provides values of RH on the surface of the OSB towards the bottom of the wall; this location (marked with an X) is shown in the schematic of the test specimen to the right of each plot.

The propensity for the growth of mould at the top or bottom of the wall is shown in the lower most plot of Figure 20, in which is given the mould index value as a function of the monitoring period, in days. The mould index value is based on a mathematical relationship developed by criteria developed by Hukka and Viitanen [6], Viitanen and Ojanen [7], and Ojanen et al. [8] in which values for RH and T and information on the type of surface onto which mould may grow permits establishing the susceptibility to mould growth; values for mould index may range between 0 and 6, where 0 represents no mould growth and 6, very heavy (100% coverage) and tight growth. Its application to providing information on wall performance is more fully described in [3]; additional details regarding the mould index is provided in Appendix 3.

It is perhaps apparent that the RH (blue lines) at both the top and bottom locations in the wall experienced levels of RH ranging between 50 and 60% during period A, whereas these levels during period B increase significantly. Recalling that period B of the test protocol (see Table 2) was one where purposely placed deficiencies in the wall were open to permit the passage of warm air (21°C) from the interior and through the wall to the exterior. The RH in these instances attained ca. 85% RH at the top of the wall (uppermost plot) and ca. 100% RH (middle plot) at the bottom of the wall, suggesting that with a sufficiently low temperature, condensation could readily occur on the surfaces of the OSB. The values of T used to calculate the mould index are the same as those given in the uppermost plot (top off the wall) for reasons previously explained; these values range from -20 to 0°C.

Thus condensation could occur at these locations, and this is evident from the information provided in Figure 23 in which is shown the response of electrical resistance to the presence of

moisture at locations provided in the figure. The response of the moisture detection strips to the presence of moisture is marked with a decrease in electrical resistance which manifests itself by an increase in the value for conductivity. The increase in values for conductivity during period B denote the presence of condensation whereas the dissipation of moisture from the same locations in Period C is evidence from decreases in values over time; no moisture detected in Period D. This implies that all moisture that was deposited in the wall over this period could readily dissipate from the wall assembly.

In respect to the risk for mould growth, given the low temperatures on the wall surface, and moreover that mould does not grow at temperatures below 0°C, the propensity for mould growth during Period B was nil. However, as the temperature at these locations increased over Period C, the susceptibility to mould growth at these locations likewise increased, although, given the ever decreasing level of RH over the same period, the mould index values considerably abated in Period C. Overall, the susceptibility to mould growth in this wall was low.

Response of W5 (SPF) — The response of W5 is provided in plots of relative humidity and temperature (RH & T) as a function of the monitoring period in days as provided in Figure 21; as before, periods A to D are highlighted at the base of the figure. The uppermost and middle plots of Figure 21 represent the RH (blue color) and T (red colour) on the surface of the interior side of the OSB, respectively, at approximately mid-height and towards the bottom of the wall; both these locations (marked with an X) are shown in the schematic of the test specimen to the right of each plot. The propensity for the growth of mould at the top or bottom of the wall is shown in the lowermost plot of Figure 21, in which is given the mould index value as a function of the monitoring period, in days.

As was the case for W4, the RH at both the top and bottom locations in test specimen W5 experienced levels of RH ranging between 35 and 65% during period A, whereas these levels during period B, again, increased significantly. In period B, values of RH attained upwards of 85% at the bottom location and 95% at the top location; the corresponding temperatures were again quite low, reaching -20°C. As such, the propensity to the formation on condensation was high although whereas the risk to the formation of mould low.

The information provided in Figure 24 shows the response of electrical resistance to the presence of moisture at locations provided in the figure. The increase in values for conductivity during period B denote the presence of condensation whereas the dissipation of moisture from the same locations in Period C is evident from decreases in values over time; no moisture detected in Period D as was the case for W4. This implies that all moisture that was deposited in the wall over this period could readily dissipate; this is the same response as was found for W4.

The risk to the growth of mould diminished over period C irrespective of the increase in temperature over this period and the subsequent period of monitoring. Overall, the susceptibility to mould growth in this wall was low.

Response of W6 (CFI) — The response of W6 is provided in plots of relative humidity and temperature (RH & T) as a function of the monitoring period in days as provided in Figure 22; as before, periods A to D are highlighted at the base of the figure. The uppermost and middle plots of Figure 22 represent the RH (blue color) and T (red color) on the surface of the interior side of

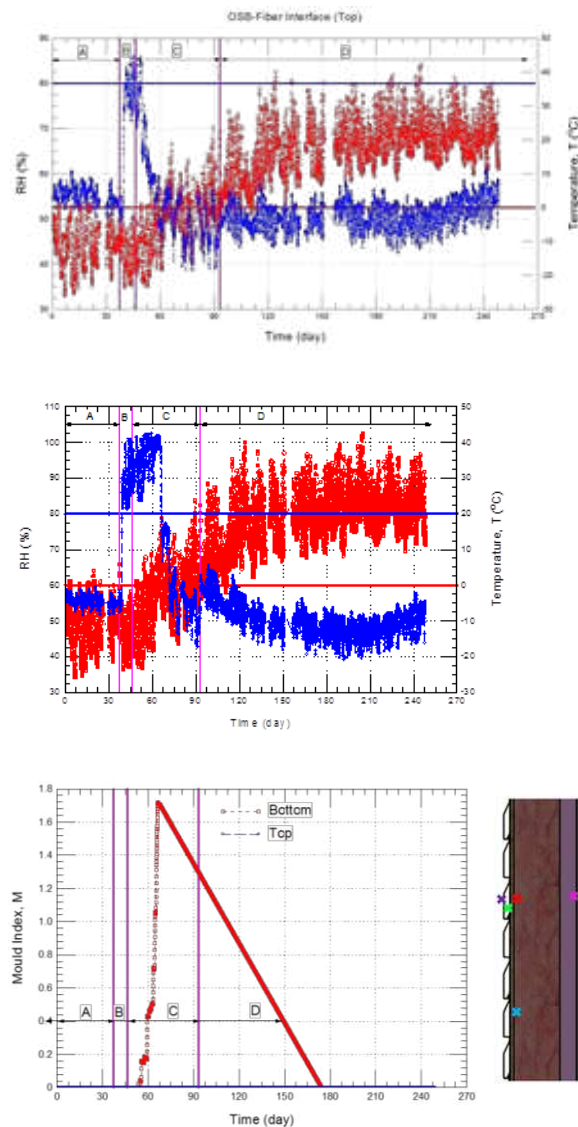

Figure 20 – Response of test wall W4 (XPS) to local weather of Ottawa (ON), Canada – having a nominal R-value of R33;

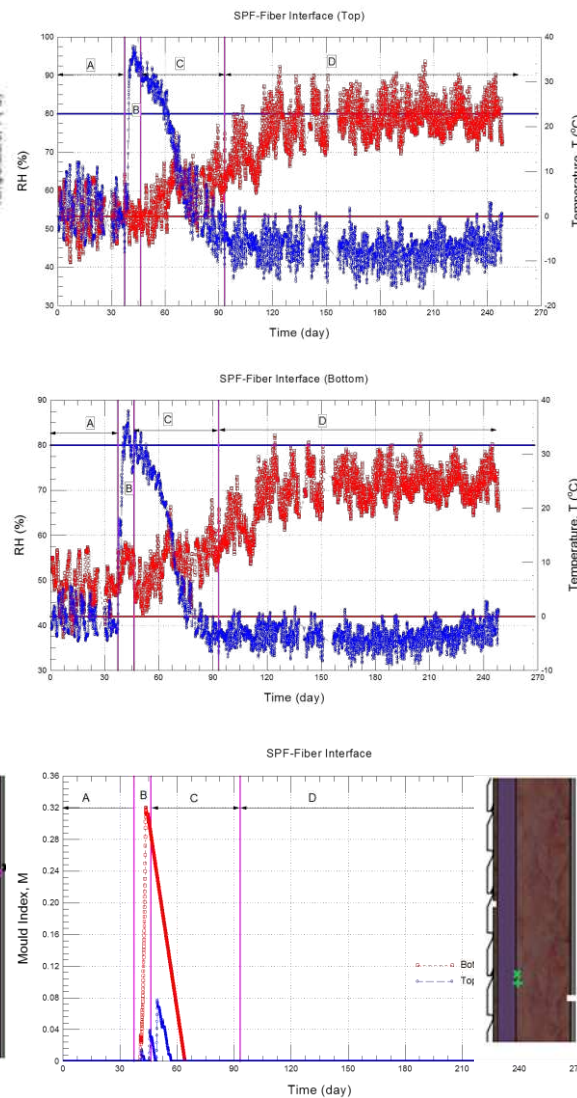

Figure 21 – Response of test wall W5 (SPF) to local weather load of Ottawa (ON), Canada – having a nominal R-value of R42;

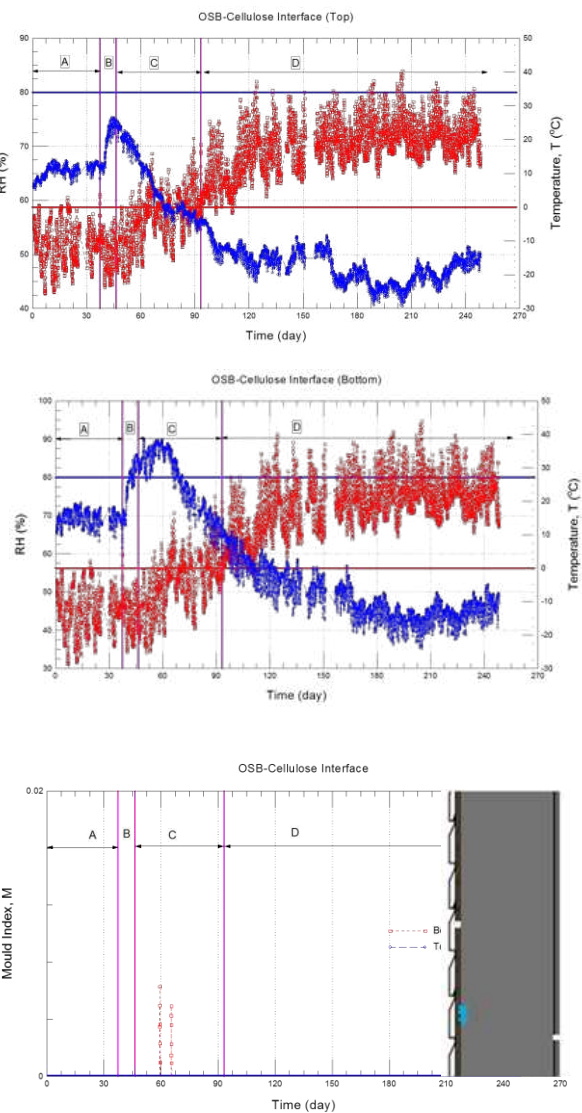

Figure 22 – Response of test wall W6 (CFI) to local weather of Ottawa (ON), Canada – having a nominal R-value of R40;

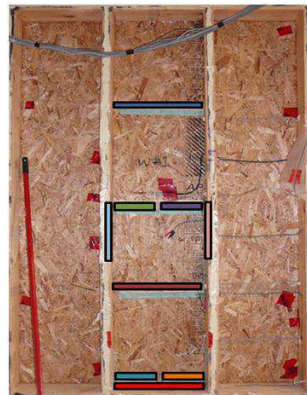
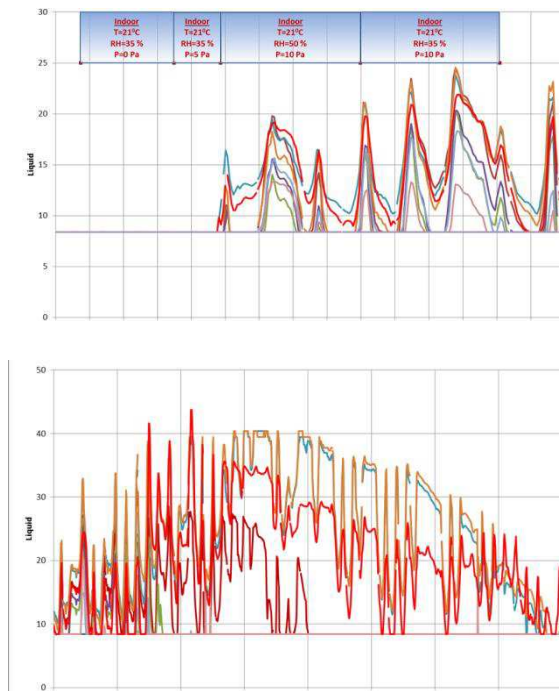

Figure 23 – W4 : Response of moisture detection strip to the presence of moisture in the wall

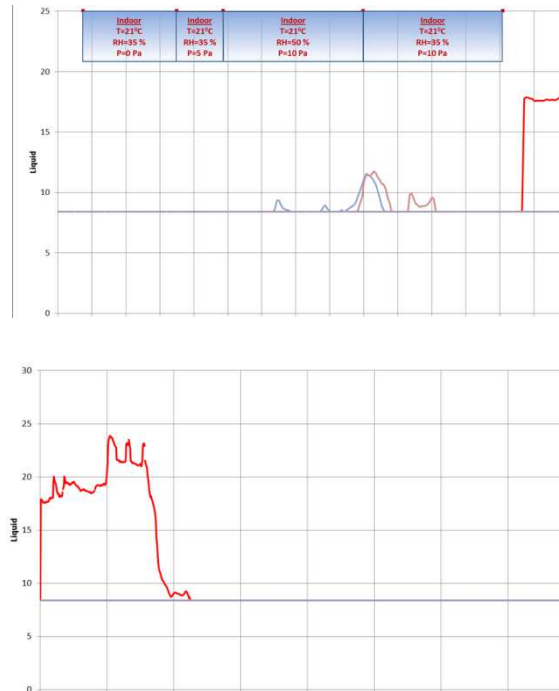

Figure 24– W5: Response of moisture detection strip to the presence of moisture in the wall

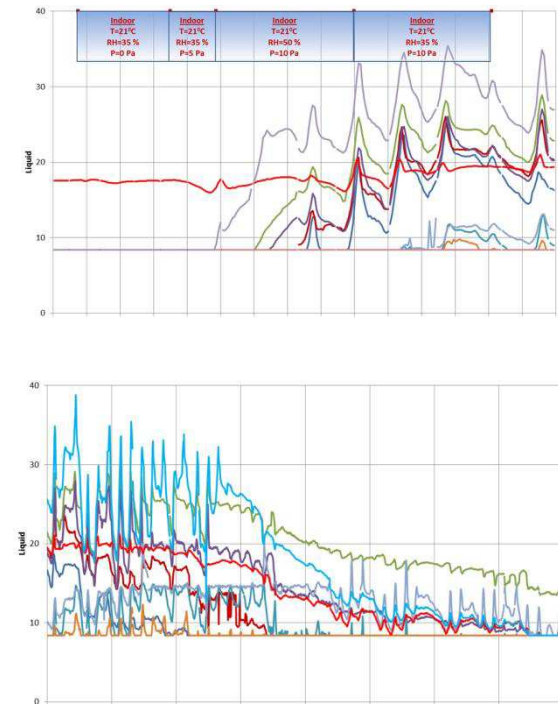

Figure 25– W6: Response of moisture detection strip to the presence of moisture in the wall

the OSB, respectively, at approximately mid-height and towards the bottom of the wall; both these locations (marked with an X) are shown in the schematic of the test specimen to the right of each plot. The propensity for the growth of mould at the top or bottom of the wall is shown in the lower most plot of Figure 22. Figure 20, in which is given the mould index value as a function of the monitoring period, in days.

As for W4 and W5, the RH at both the top and bottom locations in test specimen W6 experienced levels of RH ranging between 60 and 70% during period A, whereas these levels during period B, increased, although not as significantly as was the case for W4 and W5. In period B, values of RH attained upwards of 85% at the bottom location and 75% at the top location; the corresponding temperatures in Period B were again quite low, reaching -20°C. As such, the propensity to the formation on condensation was high although the risk to the formation of mould low.

The information provided in Figure 25 shows the response of electrical resistance to the presence of moisture at locations provided in the figure. During period B the increases in values for conductivity denote the presence of condensation; this is a similar response as that determined for W4 and W5. The dissipation of moisture from the same locations in Period C is evident from decreases in values over time; no moisture detected in Period D as was the case for W4 and W5. Again, all moisture deposited in the wall over this period could readily dissipate indicative of the same response as was found for W4 and W5.

The risk to the growth of mould diminished over period C irrespective of the increase in temperature and RH over this period and the subsequent period of monitoring. Overall, the susceptibility to mould growth in this wall was low.

4.0 Summary of Response of Walls assemblies - Phases 1 and 2

The hygrothermal response of 6 highly insulated wood frame wall assemblies (Phase 2 summary provided in Figure 26) was monitored over a two year period to determine whether any of these walls were susceptible to moisture problems that might accrue from inadvertent condensation in the wall assemblies. The walls were subjected to local climate conditions of Ottawa, Canada. To determine the vulnerability of the wall assemblies and to assess their robustness to moisture ingress from air leakage, all assemblies were configured to include openings in the air barrier and exterior sheathing paneled to permit the passage of air exfiltration from or infiltration to an interior conditioned enclosure.

Results from this study show that in instances where openings for air leakage exists, there is a risk to condensation in wall assemblies; however, this risk is mitigated by the low risk to the formation of mould (Viitanen mould index value less than 1) given the very low temperatures that exist on the interior surface of the exterior OSB sheathing panel and as well, the ability for moisture to dissipate from within the wall in a period of 2-3 months should moisture be present within the wall.

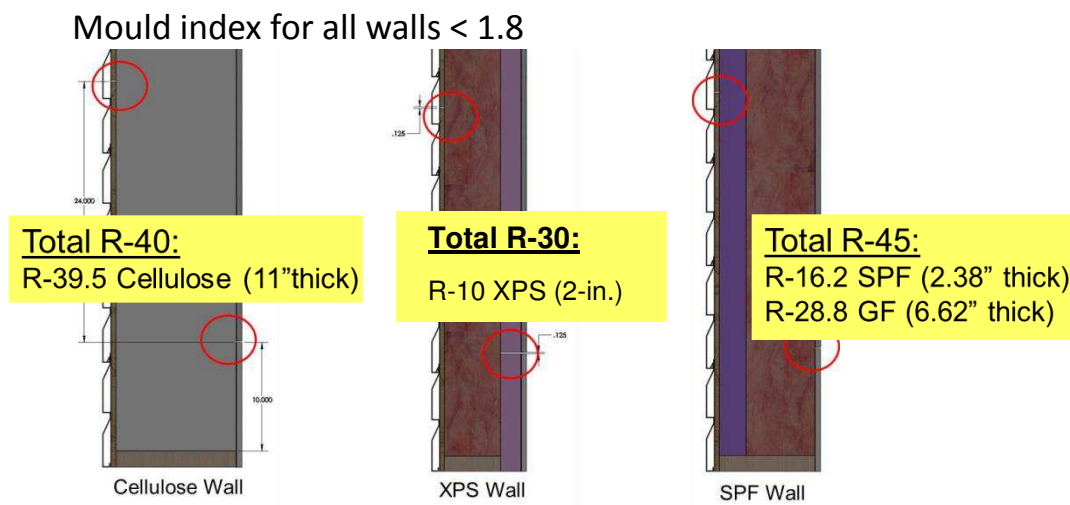

Figure 26— summary of Response of Walls assemblies - Phases 1 and 2

5.0 References

1. Reference on Canadian market for new residential home construction and existing retrofits
2. Reference on : 2025, highly-insulated (enhanced) envelopes could save 11.6 PJ of energy and 1.2 Mt of Green House Gas per year
3. Saber, H. H. and Ganapathy, G., "Evaluation of Thermal and Moisture Response of Highly Insulated Wood-Frame Wall Assemblies — Phase 1; Part II: Numerical Modelling"; Report No. A1-000444.4; NRC-Construction, National Research Council of Canada, Ottawa, Canada; 12 January, 2016; 83 p.
4. ASTM Designation: C 1130-07, "Standard Practice for Calibrating Thin Heat Flux Transducers", Annual Book of ASTM Standards; Construction, vol. 04.06, Thermal Insulation; Building & Environment Acoustic, pp. 577-584, 2009.
5. ASHRAE. 2009. 2009 ASHRAE Handbook –Fundamentals (SI), Chapter 26, Atlanta: American Society of Heating, Refrigerating, and Air-Conditioning Engineers Inc.
6. Hukka, A., and Viitanen, H.A., "A mathematical model of mould growth on wooden material, Wood Science and Technology", vol. 33 (6), pp 475-485, 1999.
7. Viitanen, H.A., and Ojanen, T., "Improved model to predict mould growth in building materials" Proceedings of Thermal Performance of the Exterior Envelopes of Whole Buildings X, 8 p., 2007.
8. Ojanen, T., Viitanen, H.A., Peuhkuri, R., Lähdesmäki, K., Vinha, J., and Salminen, K., "Mould Growth Modeling of Building Structures Using Sensitivity Classes of Materials", 11th International Conference on Thermal Performance of the Exterior Envelopes of Whole Buildings XI (Clearwater, (FL), USA, December-05-10), 10 p., 2010.
9. Armstrong, M., Saber, H.H., Maref, W., Rousseau, M.Z., Ganapathy, G., and Swinton, M.C., "Field Energy Performance of an Insulating Concrete Form (ICF) Wall", 13th CCBST conference - Winnipeg 2011, The 13th Canadian Conference on Building Science and Technology, Winnipeg, Manitoba May 10 – 13, 2011.

10. Maref, W., Armstrong, M. M., Rousseau, M.Z., Thivierge, C., Nicholls, M., Ganapathy, G. and Lei, W., "Field Hygrothermal Performance of retrofitted Wood-Frame Wall Assemblies in Cold Climate", 13th Canadian Conference on Building Science and Technology - Winnipeg, Canada, 2011.
11. Maref, W., Rousseau, M.Z., Armstrong, M.M., Lee, W., Leroux, M., and Nicholls, M., Evaluating the Effects of Two Energy Retrofit Strategies for Housing on the Wetting and Drying Potential of Wall Assemblies: Summary Report for Year 2007-08 Phase of the Study, Report RR-315, pp. 1-118, NRC Institute for Research in Construction, 2011.
12. Saber, H.H., and Maref, W., "Risk of Condensation and Mould Growth in Wood-Frame Wall Systems with Different Exterior Insulations", BEST Building Enclosure Science & Technology Conference (BEST4); April 12-15, 2015, Kansas City, Missouri, USA, 19 p.
13. Saber, H.H., Maref, W., Gnanamurugan, G., and Nicholls, M., "Energy Retrofit Using VIPs: - an Alternative Solution for Enhancing the Thermal Performance of Wood-Frame Walls", Journal of Building Physics, vol. 39(1), pp. 35-68, 2015.

Appendix 1

Test Specimen Fabrication and Installation details

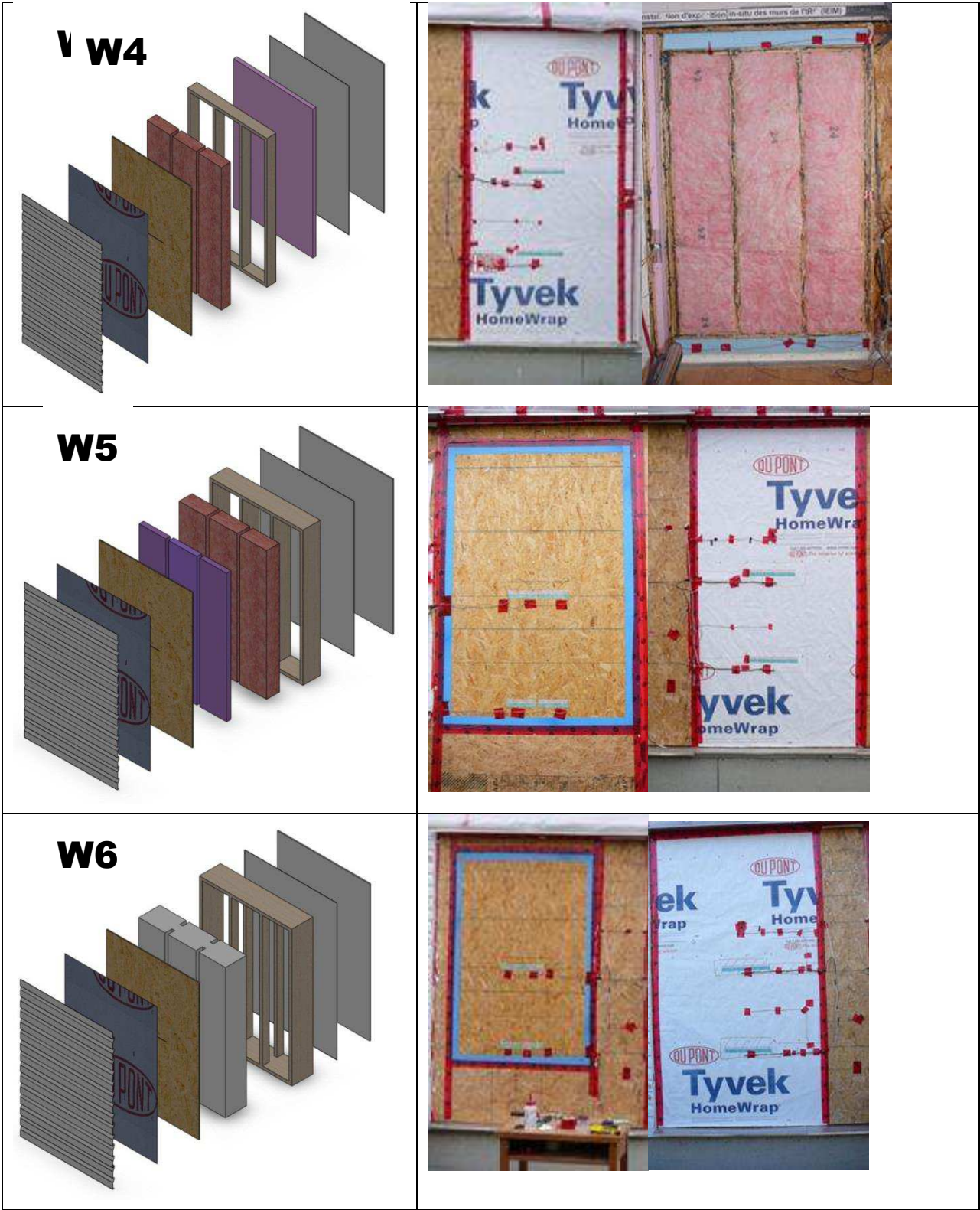



Appendix 2

Test Specimen Sensor Installation Details

Phase 1 test specimens - Location of temperature thermocouples (TC)

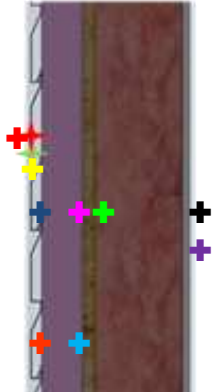
W1 – Location of thermocouple (T)	Designation		
Exterior temperature	B1_TC_01	+	
Exterior temperature	B1_TC_02	+	
Behind cladding at top	B1_TC_03	+	
Behind cladding at bottom	B1_TC_04	+	
T at EPS-OSB interface at top	B1_TC_09	+	
T at EPS-OSB interface at bottom	B1_TC_10	+	
OSB interior surface T at top	B1_TC_11	+	
Interior T	B1_TC_17	+	
Dew point Interior T	B1_TC_18	+	

W2 – Location of thermocouple (T)	Designation		
Exterior temperature	B2_TC_01	+	
Exterior temperature	B2_TC_02	+	
Behind cladding at top	B2_TC_03	+	
Behind cladding at bottom	B2_TC_04	+	
T at EPS-OSB interface at top	B2_TC_09	+	
T at EPS-OSB interface at bottom	B2_TC_10	+	
OSB interior surface T at top	B2_TC_11	+	
Interior T	B2_TC_17	+	
Dew point Interior T	B2_TC_18	+	

W3 – Location of thermocouple (T)	Designation		
Exterior temperature	B3_TC_01	+	
Exterior temperature	B3_TC_02	+	
Behind cladding at top	B3_TC_03	+	
Behind cladding at bottom	B3_TC_04	+	
T at EPS-OSB interface at top	B3_TC_09	+	
T at EPS-OSB interface at bottom	B3_TC_10	+	
OSB interior surface T at top	B3_TC_11	+	
Interior T	B3_TC_17	+	
Dew point Interior T	B3_TC_18	+	

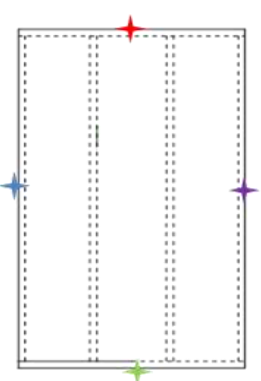
W1 – Location of thermocouple (T)	Designation		
Middle stud cavity at top	B1_TC_12	+	
Mid-height stud cavity – right cavity	B1_TC_13	+	
Middle stud cavity at bottom	B1_TC_14	+	
Mid-height stud cavity – left cavity	B1_TC_15	+	

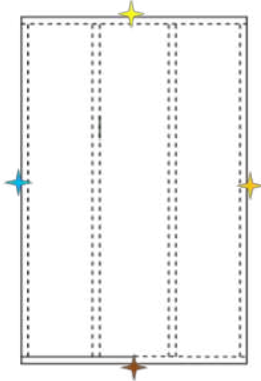
W2 – Location of thermocouple (T)	Designation		
Middle stud cavity at top	B2_TC_12	+	
Mid-height stud cavity – right cavity	B2_TC_13	+	
Middle stud cavity at bottom	B2_TC_14	+	
Mid-height stud cavity – left cavity	B4_TC_15	+	

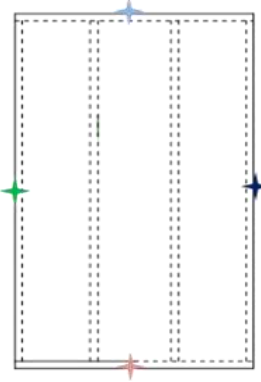
W3 – Location of thermocouple (T)	Designation		
Middle stud cavity at top	B3_TC_12	+	
Mid-height stud cavity – right cavity	B3_TC_13	+	
Middle stud cavity at bottom	B3_TC_14	+	
Mid-height stud cavity – left cavity	B3_TC_15	+	

Phase 1 test specimens - Location of relative humidity sensors (RH)

W1 – Location of RH sensors	Designation		
Exterior RH	B1_RHT_01	×	
Behind cladding at top	B1_RHT_02	×	
Behind cladding at bottom	B1_RHT_03	×	
EPS-OSB interface at top	B1_RHT_04	×	
EPS-OSB interface at bottom	B1_RHT_05	×	
OSB interior surface RH at top	B1_RHT_06	×	
Interior surface RH	B1_RHT_08	×	

W2 – Location of RH sensors	Designation		
Exterior RH	B2_RHT_01	×	
Behind cladding at top	B2_RHT_02	×	
Behind cladding at bottom	B2_RHT_03	×	
XPS-OSB interface at top	B2_RHT_04	×	
XPS-OSB interface at bottom	B2_RHT_05	×	
OSB interior surface RH at top	B2_RHT_06	×	
Interior surface RH	B2_RHT_08	×	

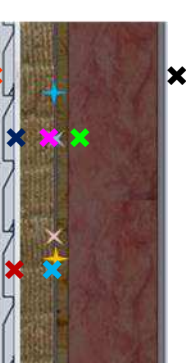
W3 – Location of RH sensors	Designation		
Exterior RH	B3_RHT_01	×	
Behind cladding at top	B3_RHT_02	×	
Behind cladding at bottom	B3_RHT_03	×	
Mineral fibre-OSB interface at top	B3_RHT_04	×	
Mineral fibre-OSB interface at bottom	B3_RHT_05	×	
OSB interior surface RH at top	B3_RHT_06	×	
Interior surface RH	B3_RHT_08	×	

Phase 1 test specimens - Location of Heat Flux (HF) transducers

W1 – Location of HF transducers	Designation		
Exterior surface of EPS	B1_HFT_01	●	
Exterior surface of OSB panel	B1_HFT_02	●	
Exterior facing surface of drywall	B1_HFT_03	●	

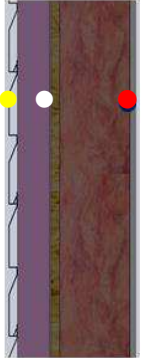
W2 – Location of HF transducers	Designation		
Exterior surface of XPS	B2_HFT_01	●	
Exterior surface of OSB panel	B2_HFT_02	●	
Exterior facing surface of drywall	B2_HFT_03	●	

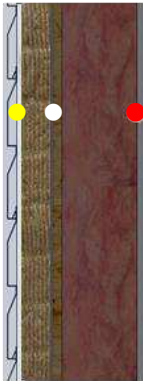
W3 – Location of HF transducers	Designation		
Exterior surface of mineral fibre	B3_HFT_01	●	
Exterior surface of OSB panel	B3_HFT_02	●	
Exterior facing surface of drywall	B3_HFT_03	●	

Phase 2 test specimens - Location of pressure sensors (DP)

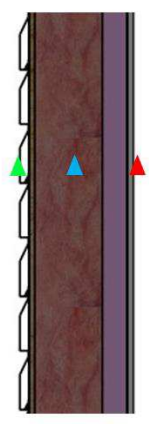
W4 – Location of pressure sensors		Designation		
Exterior	B1_DP_01		▲	
Stud cavity	B1_DP_02		▲	
Interior	B1_DP_03		▲	

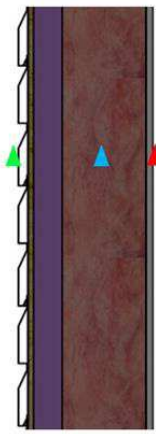
W5 – Location of pressure sensors		Designation		
Exterior	B2_DP_01		▲	
Stud cavity	B2_DP_02		▲	
Interior	B2_DP_03		▲	

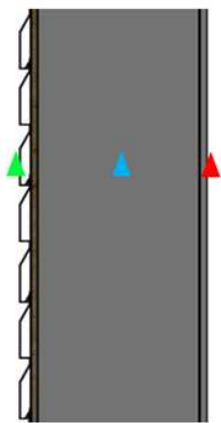
W6 – Location of pressure sensors		Designation		
Exterior	B3_DP_01		▲	
Stud cavity	B3_DP_02		▲	
Interior	B3_DP_03		▲	

Phase 2 test specimens - Location of temperature thermocouples (TC)

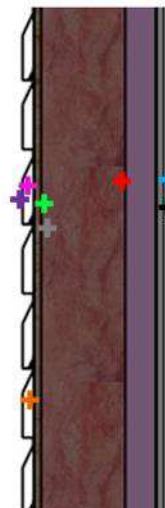
W4 – Location of temperature (T)	Designation		
Exterior temperature	B1_TC_02	+	
Dew point OSB interior surface T	B1_TC_06	+	
Batt insulation and XPS interface	B1_TC_08	+	
Behind cladding at top	B1_TC_09	+	
Behind cladding at bottom	B1_TC_10	+	
OSB interior surface T at top	B1_TC_11	+	
Interior T	B1_TC_18	+	
Dew point Interior T		+	

W5 – Location of temperature (T)	Designation		
Exterior temperature	B2_TC_02	+	
Dew point SPF interior surface T	B2_TC_06	+	
SPF interior surface T	B2_TC_08	+	
Behind cladding at top	B2_TC_09	+	
Behind cladding at bottom	B2_TC_10	+	
OSB interior surface T at top	B2_TC_11	+	
Interior T	B2_TC_18	+	
Dew point Interior T		+	

W6 – Location of temperature (T)	Designation		
Exterior temperature	B3_TC_02	+	
Dew point OSB interior surface T	B3_TC_06	+	
Behind cladding at top	B3_TC_09	+	
Behind cladding at bottom	B3_TC_10	+	
OSB interior surface T at top	B3_TC_11	+	
Interior T	B3_TC_18	+	
Dew point Interior T		+	

Phase 2 test specimens - Location of Relative humidity sensors (RH)

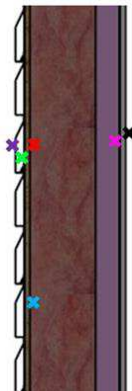
W4 – Location of RH sensors	Designation		
Exterior RH	B1_RHT_01	×	
OSB interior surface RH at bottom	B1_RHT_02	×	
Cavity RH at polyethylene v. barrier	B1_RHT_03	×	
Behind cladding at top	B1_RHT_04	×	
OSB interior surface RH at top	B1_RHT_06	×	
Interior RH	B1_RHT_08	×	

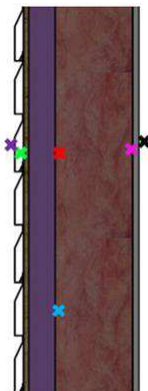
W5 – Location of RH sensors	Designation		
Exterior RH	B2_RHT_01	×	
OSB interior surface RH at bottom	B2_RHT_02	×	
Cavity RH at polyethylene v. barrier	B2_RHT_03	×	
Behind cladding at top	B2_RHT_04	×	
OSB interior surface RH at top	B2_RHT_06	×	
Interior RH	B2_RHT_08	×	

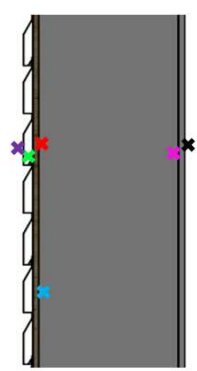
W6 –Location of RH sensors	Designation		
Exterior RH	B3_RHT_01	×	
OSB interior surface RH at bottom	B3_RHT_02	×	
Cavity RH at polyethylene v. barrier	B3_RHT_03	×	
Behind cladding at top	B3_RHT_04	×	
OSB interior surface RH at top	B3_RHT_06	×	
Interior RH	B3_RHT_08	×	

Phase 2 test specimens - Location of moisture and liquid sensing tapes

W4 - Location of DETEC moisture sensing tapes in stud cavity

- 108-Mois_Inside OSB@Top
- 109-Mois_Inside OSB@Mid-Bottom
- 110-Mois_Inside OSB-Under Slit@left
- 111-Mois_Inside OSB-Under Slit@right
- 112-Mois_Inside OSB@Bottom left
- 113-Mois_Inside OSB@Bottom right
- 114-Mois_Mid cavity_ On left side Stud under Slit
- 115-Mois_Mid cavity_ On right side Stud under Slit
- 116-Mois_Bottom Stud Track

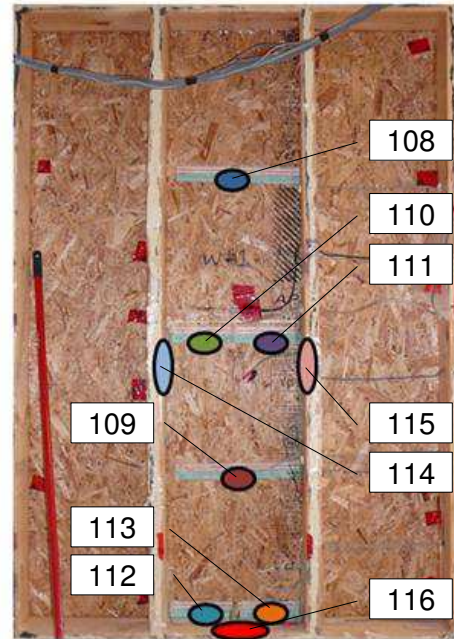

W5 - Location of DETEC moisture sensing tapes in stud cavity

- 208-Mois_Inside OSB@Top
- 209-Mois_Inside OSB@Mid-Bottom
- 210-Mois_Inside OSB-Under Slit@left
- 211-Mois_Inside OSB-Under Slit@right
- 212-Mois_Inside OSB@Bottom left
- 213-Mois_Inside OSB@Bottom right
- 214-Mois_Mid cavity_ On left side Stud under Slit
- 215-Mois_Mid cavity_ On right side Stud under Slit
- 216-Mois_Bottom Stud Track
- 217-M Inside Stud

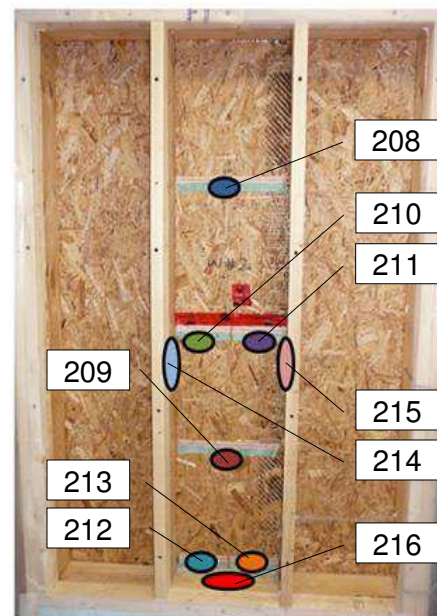

W6 - Location of DETEC moisture sensing tapes in stud cavity

- 310-Mois_Inside OSB-Under Slit@left
- 311-Mois_Inside OSB-Under Slit@right
- 312-Mois_Inside OSB@Bottom left
- 313-Mois_Inside OSB@Bottom right
- 314-Mois_Mid cavity_ On left side Stud under Slit
- 315-Mois_Mid cavity_ On right side Stud under Slit
- 316-Mois_Bottom Stud Track
- 304-Mois_Inside OSB@Top
- 305-Mois_Inside OSB@ Mid-Bottom

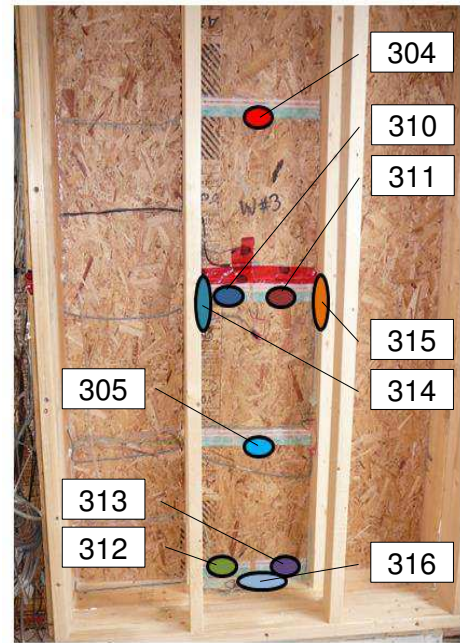

W4 - Location of DETEC moisture sensing tapes - presence of liquid in stud cavity

- 108-Liq_Inside OSB@Top
- 109-Liq_Inside OSB@Mid-Bottom
- 110-Liq_Inside OSB-under Slit@left
- 111-Liq_Inside OSB-Under Slit@right
- 112-Liq_Inside OSB@Bottom left
- 113-Liq_Inside OSB@Bottom right
- 114-Liq_Mid cavity_ On left side Stud under Slit
- 115-Liq_Mid cavity_ On right side Stud under Slit
- 116-Liq_Bottom Stud Track

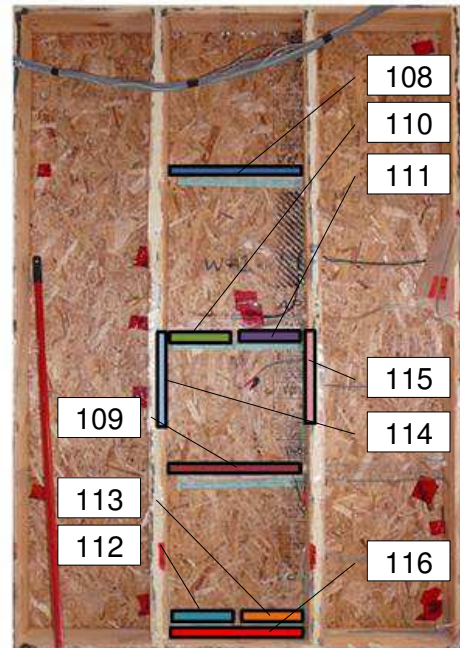

W5 - Location of DETEC moisture sensing tapes - presence of liquid in stud cavity

- 208-Liq_Inside OSB@Top
- 209-Liq_Inside OSB@Mid-Bottom
- 210-Liq_Inside OSB-Under Slit@left
- 211-Liq_Inside OSB-Under Slit@right
- 212-Liq_Inside OSB@Bottom left
- 213-Liq_Inside OSB@Bottom right
- 214-Liq_Mid cavity_ On left Stud under Slit
- 215-Liq_Mid cavity_ On right side Stud under Slit
- 216-Liq_Bottom Stud Track

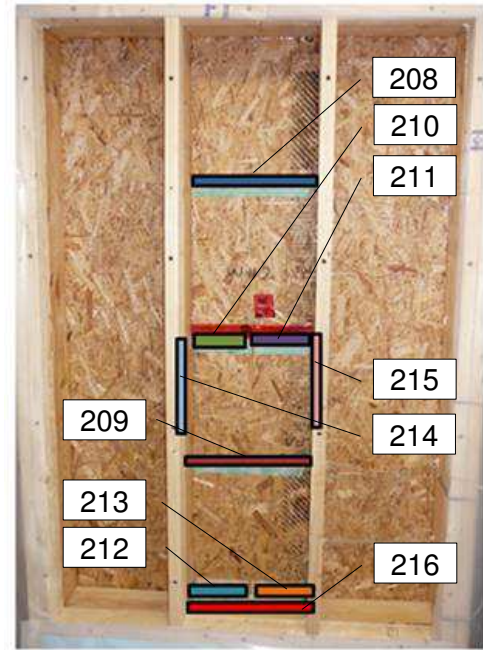

W6 - Location of DETEC moisture sensing tapes - presence of liquid in stud cavity

- 310-Liq_Inside OSB-Under Slit@left
- 311-Liq_Inside OSB-Under Slit@right
- 312-Liq_Inside OSB@Bottom left
- 313-Liq_Inside OSB@Bottom right
- 314-Liq_Mid cavity_ On left side Stud under Slit
- 315-Liq_Mid cavity_ On right side Stud under Slit
- 316-Liq_Bottom Stud Track
- 304-Liq_Inside OSB@Top
- 305-Liq_Inside OSB@ Mid-Bottom

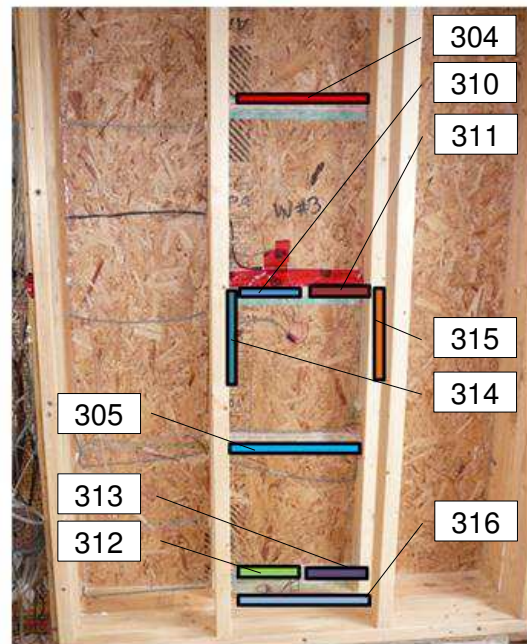

Appendix 3

Phase 1: Pressure variations over monitoring period

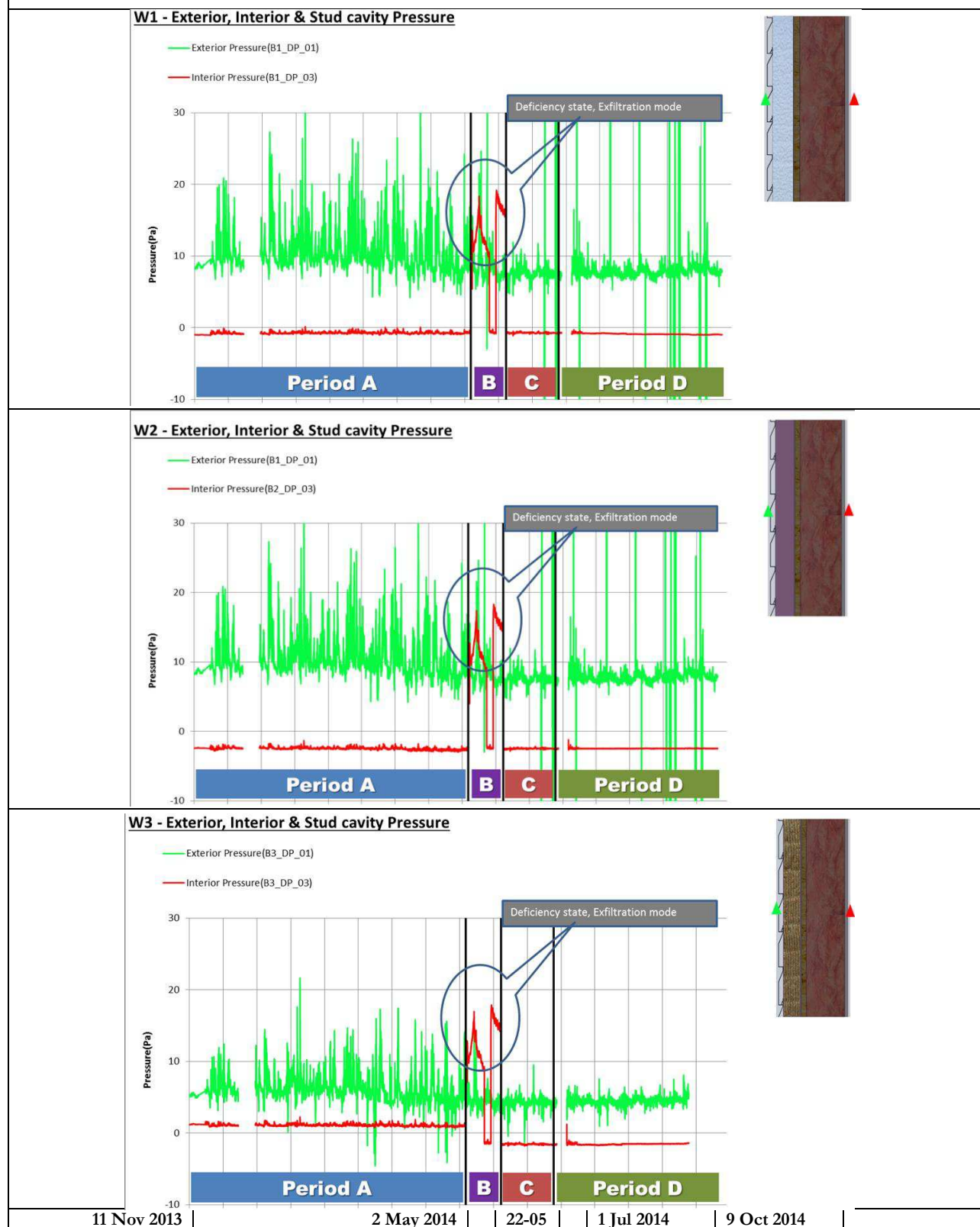

Phase 1: Temperature variations over monitoring period

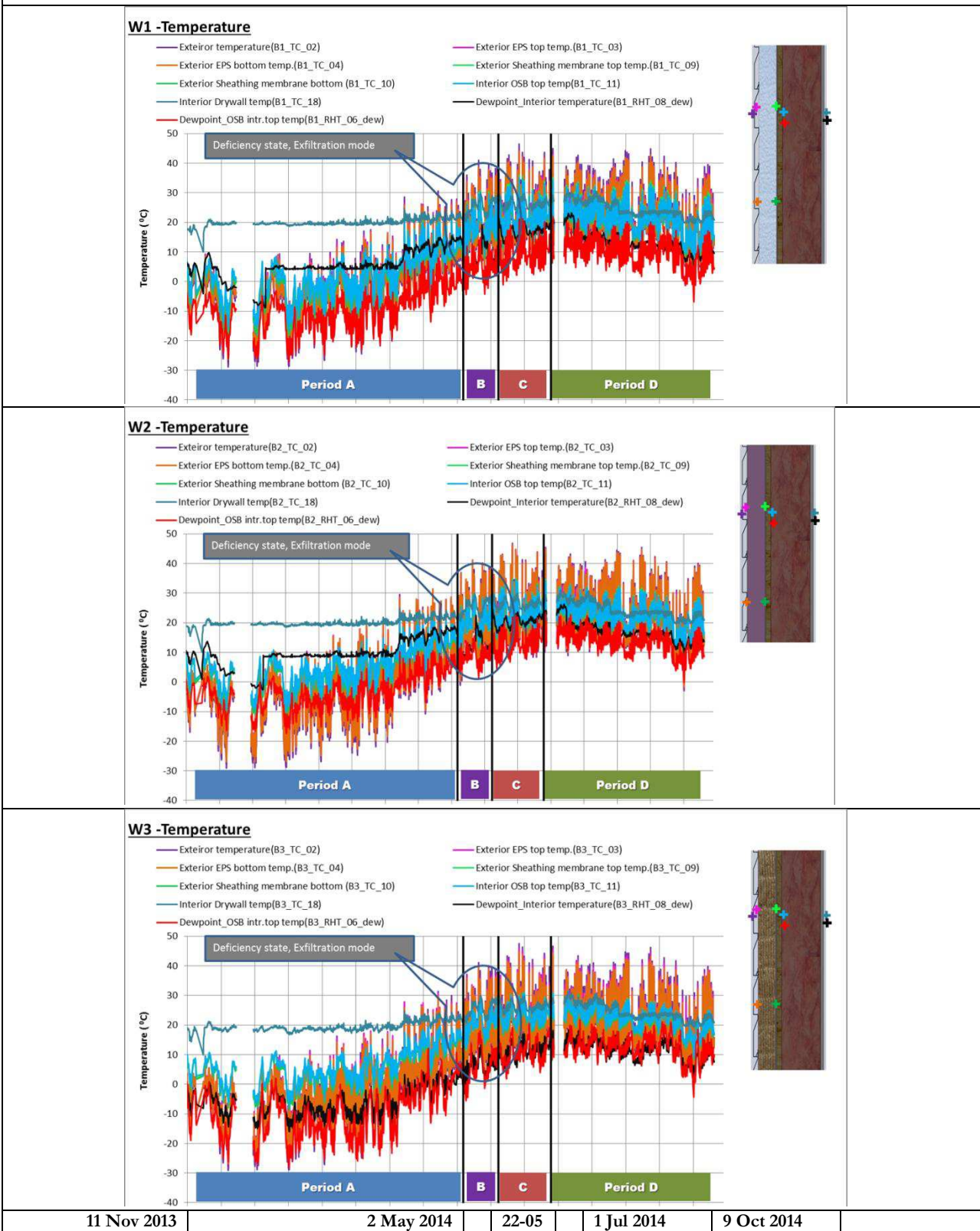

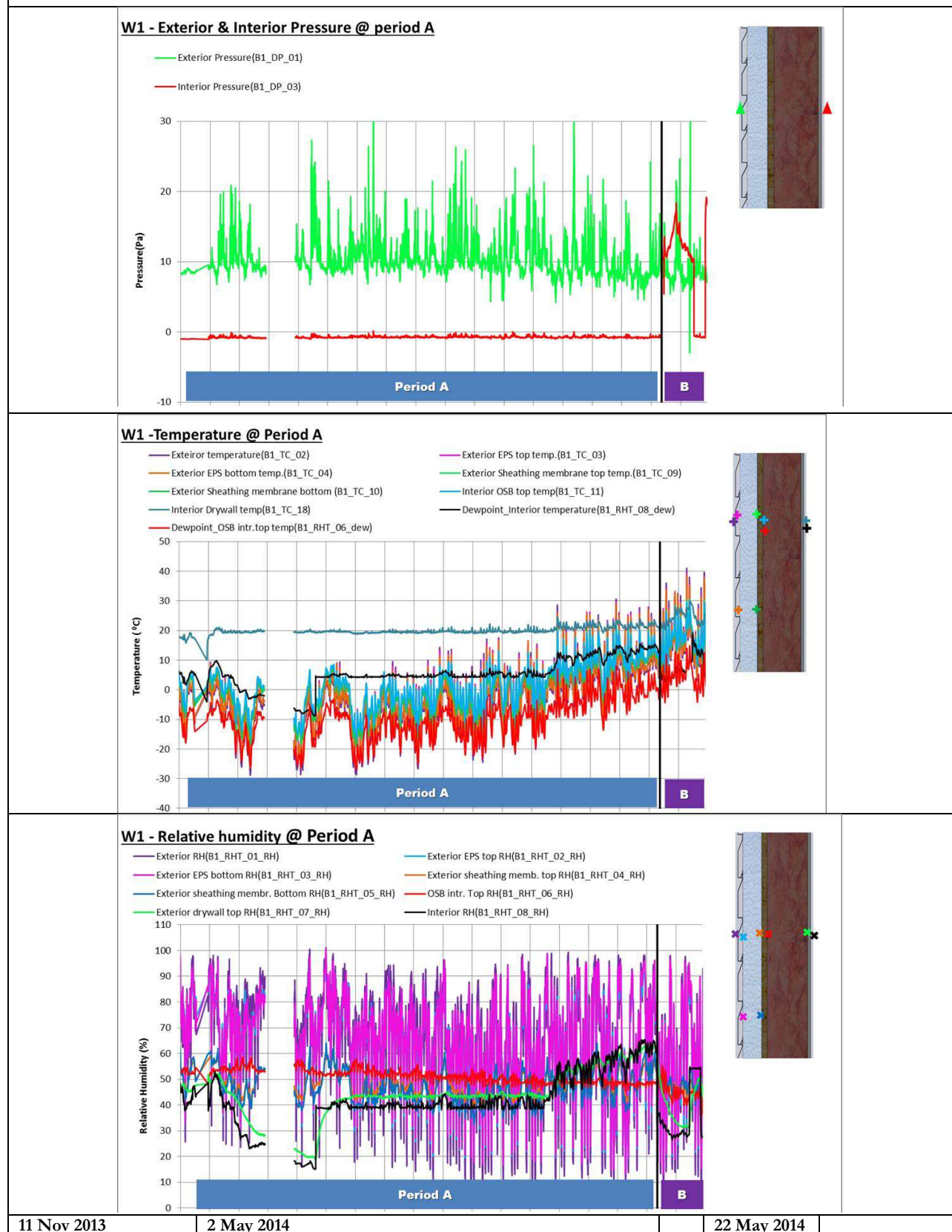
Phase 1: W1 - Pressure, T and RH variations over period A

Phase 1: W2 - Pressure, T and RH variations over period A

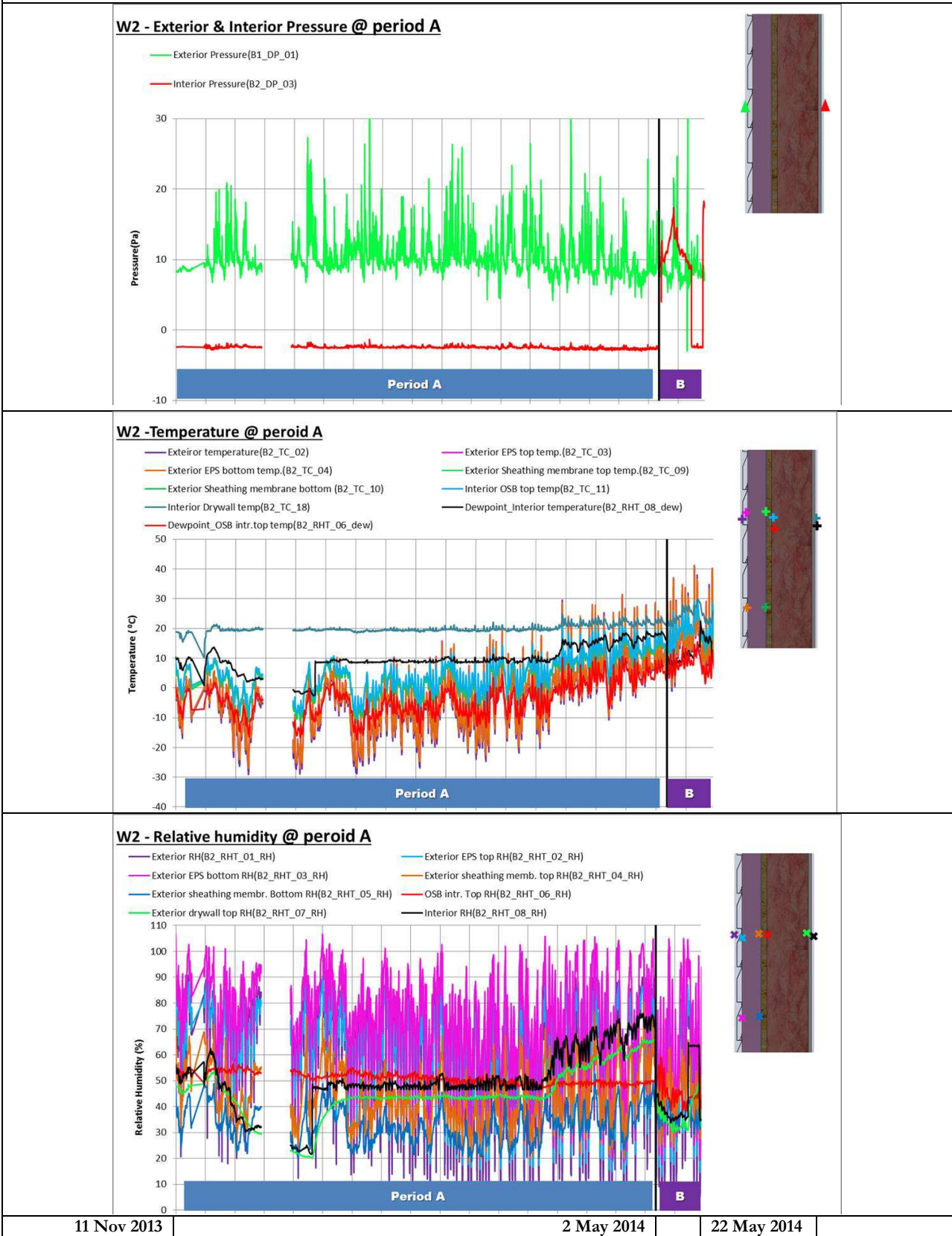

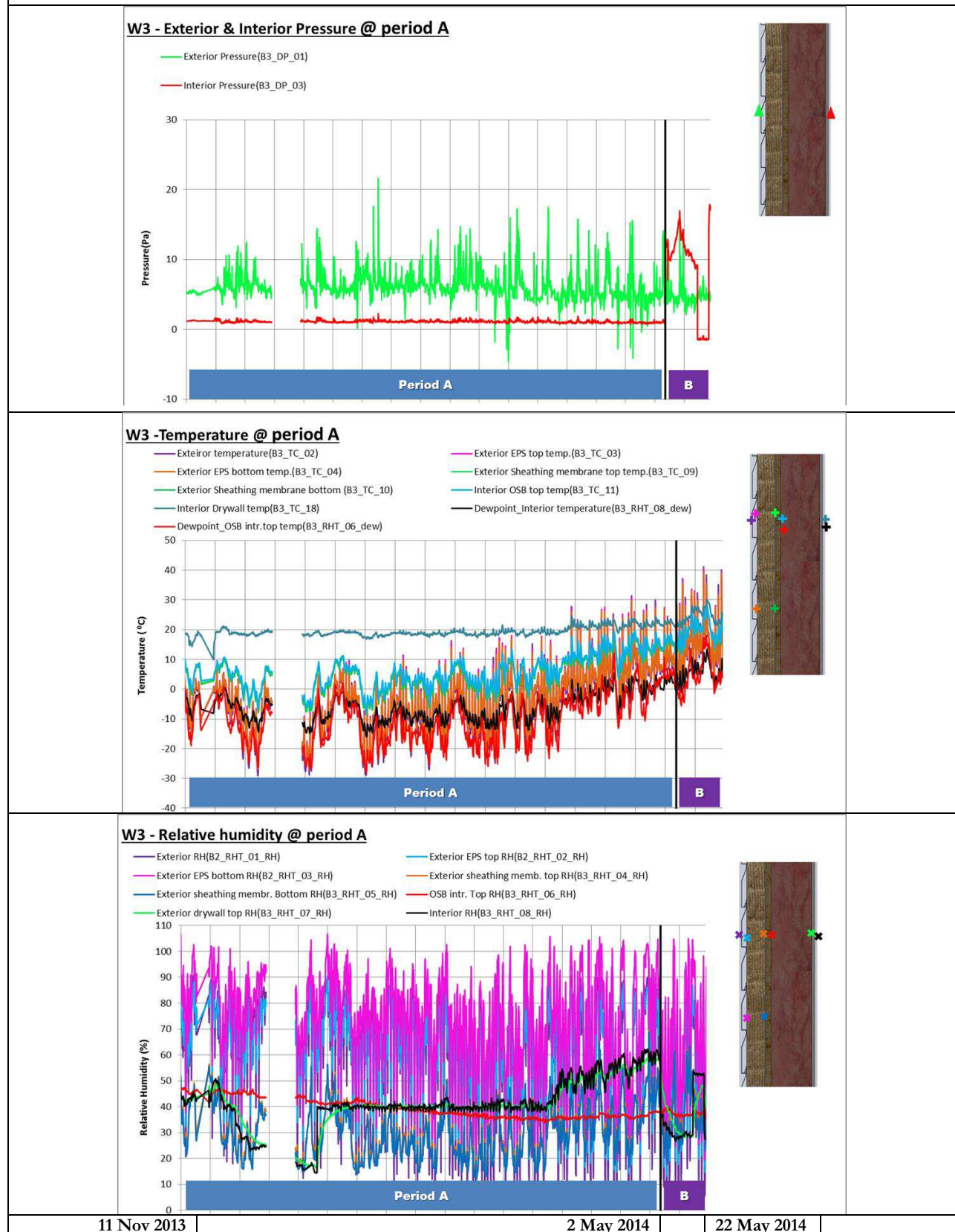
Phase 1: W3 - Pressure, T and RH variations over period A

Phase 2: W4 - Variations in pressure, T & RH over time

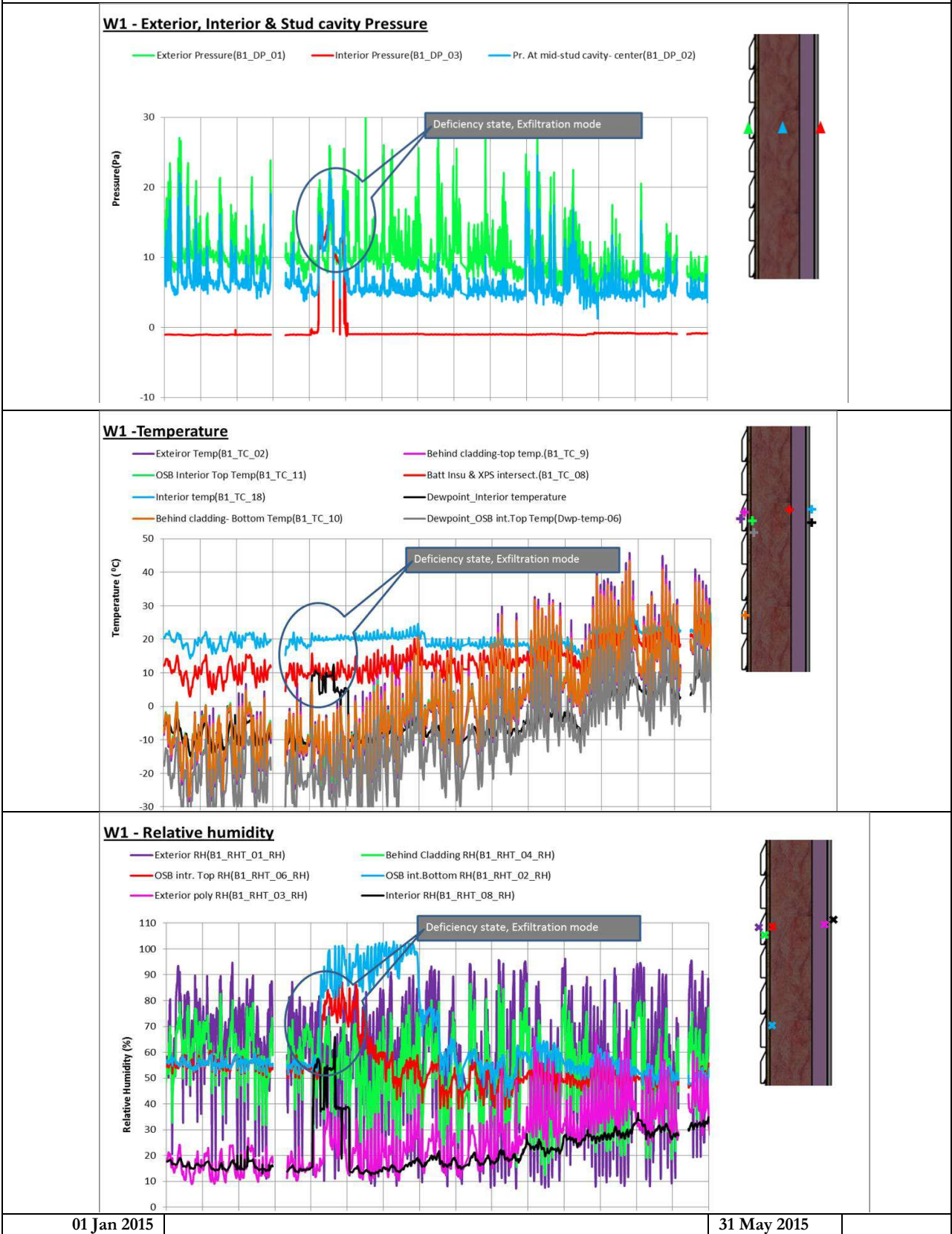

Phase 2: W5 - Variations in pressure, T & RH over time

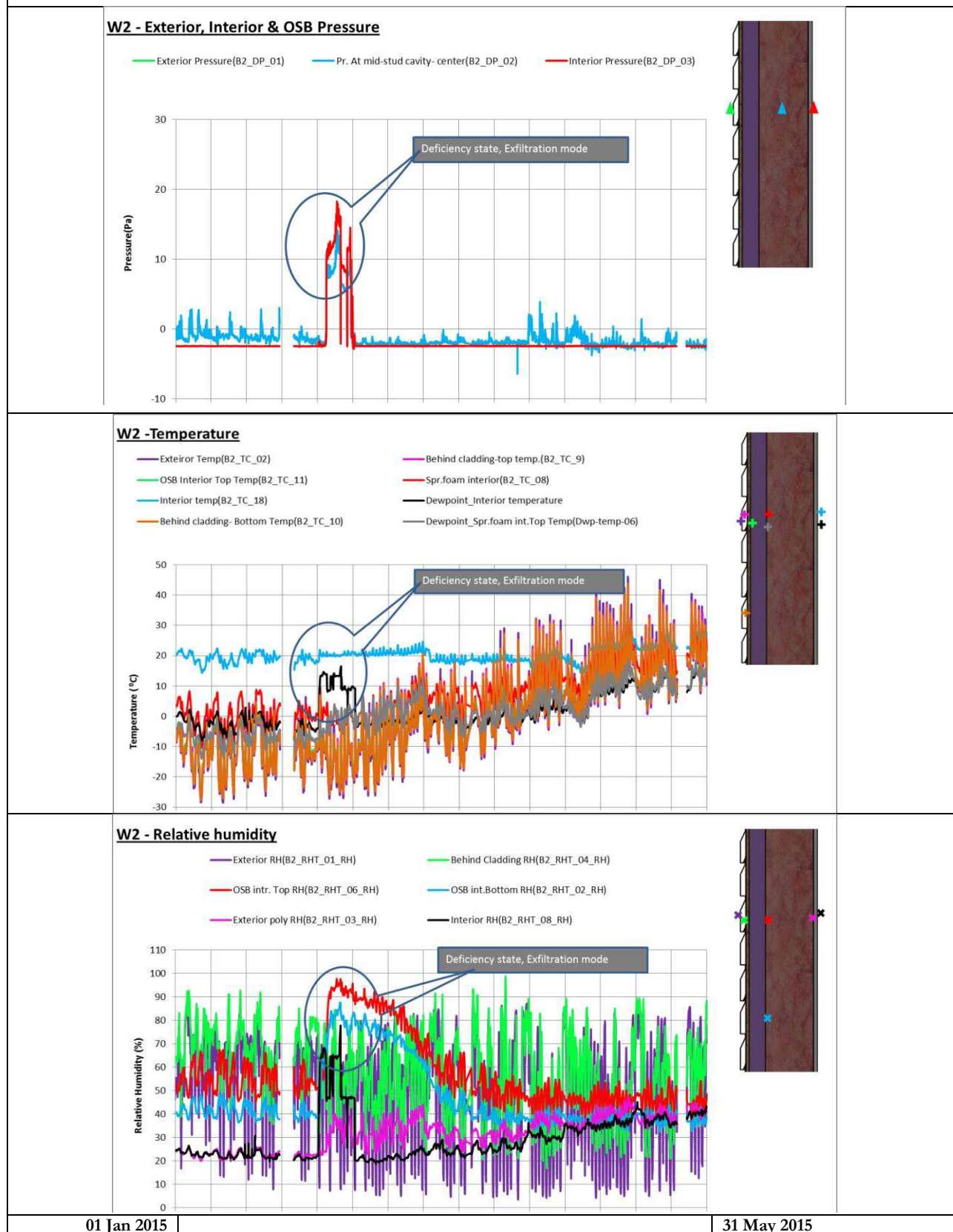

Phase 2: W6 - Variations in pressure, T & RH over time

W3 - Exterior, Interior & Stud cavity Pressure

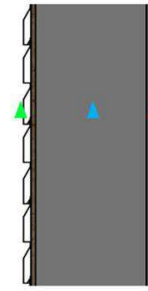
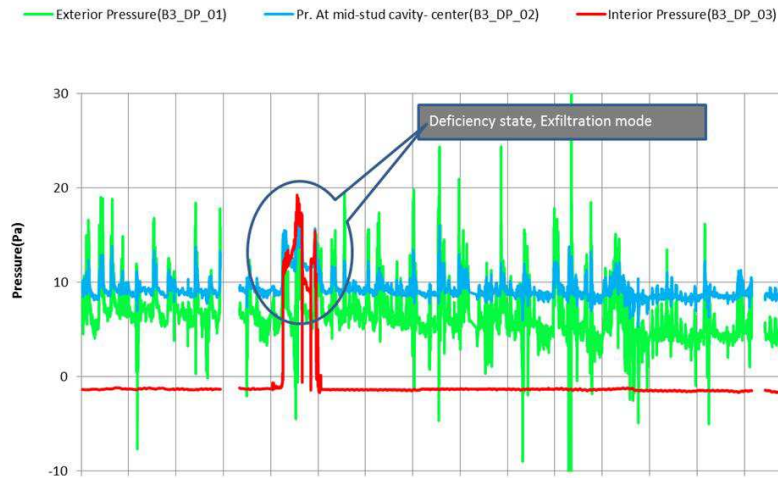

W3 -Temperature

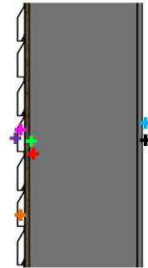
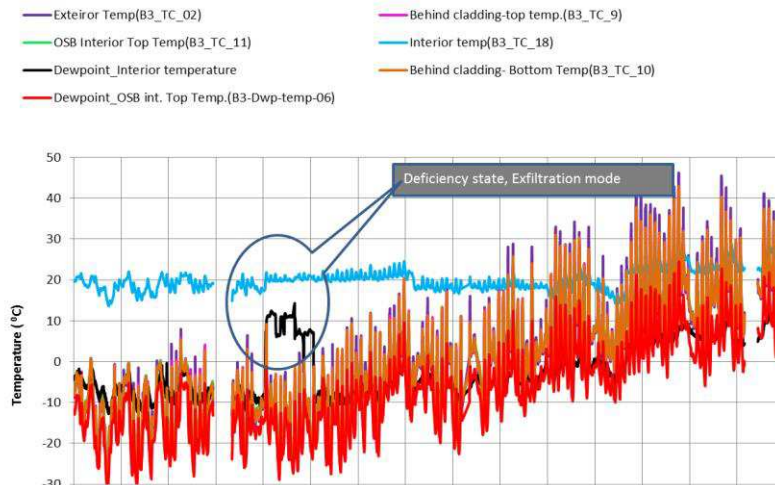

W3 - Relative humidity

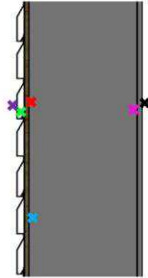
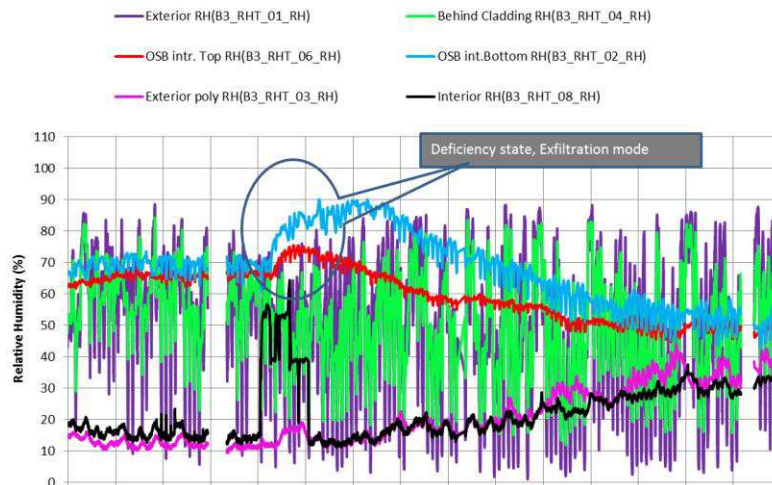

01 Jan 2015

31 May 2015

Appendix 4

Mould Index and Hygrothermal Performance

Results in Phase2 were expressed using the mould index (M) criteria developed by Hukka and Viitanen [6], Viitanen and Ojanen [7], and Ojanen et al. [8]. The most recent mould model by Ojanen et al. [8] was used in this study to determine the mould index of different materials of the wall assemblies. In that model [8], the sensitivity of different construction materials for mould growth was classified in four sensitivity classes, namely, very sensitive, sensitive, medium resistant and resistant (see Table 7). Table 8 provides the assumed correspondence of sensitivity class for materials located within the wall assembly of this study. More specifically, the sensitivity class for the top and bottom plates, OSB and foam was considered “Sensitive”, whereas the sensitivity class of the materials for cavity insulation (fiber-based), drywall and membranes was considered “Medium Resistant”.

Table 6. Description of Mould Index (M) levels [6, 7, 8]

M	Mould Index (M) Description of Growth Rate
0	No growth
1	Small amounts of mould on surface (microscope), initial stages of local growth
2	Several local mould growth colonies on surface (microscope)
3	Visual findings of mould on surface, < 10% coverage, or < 50% coverage of mould (microscope)
4	Visual findings of mould on surface, 10%–50% coverage, or > 50% coverage of mould (microscope)
5	Plenty of growth on surface, > 50% coverage (visual)
6	Heavy and tight growth, coverage about 100%

Table 7. Mould growth sensitivity classes and some corresponding materials [8]

Sensitivity Class	Materials	RH_{min} (%)[*]
Very Sensitive	Pine sapwood	80
Sensitive	Glued wooden boards, PUR with paper surface, spruce	80
Medium Resistant	Concrete, aerated and cellular concrete, glass wool, polyester wool	85
Resistant	PUR with polished surface	85

^{*} Minimum relative humidity needed for mould growth

Table 8. Mould growth sensitivity classes for materials of wall assemblies listed in Table 3

Sensitivity Class	Material Layers of Wall Assemblies	RH_{min} (%)[*]
Very Sensitive		80
Sensitive	Top plate, bottom plate, OSB, foam	80
Medium Resistant	Fiberglass insulation, gypsum, membranes	85
Resistant		85

^{*}Minimum relative humidity needed for mould to grow